



49/88 James Ruse Drive Rosehill, NSW

2 2 1

Double Storey Apartment

Located in the highly sought-after 'Pegasus' apartments, this modern residence provides an ultra-convenient lifestyle, with versatile opportunities. It's situated opposite Rosehill Gardens Racecourse, just footsteps from local shops and train station.

Price: \$480,000 - \$520,000



Aaron Lih

0420 825 598



Adam Denina

0413 546 713



4TH FLOOR



3RD FLOOR

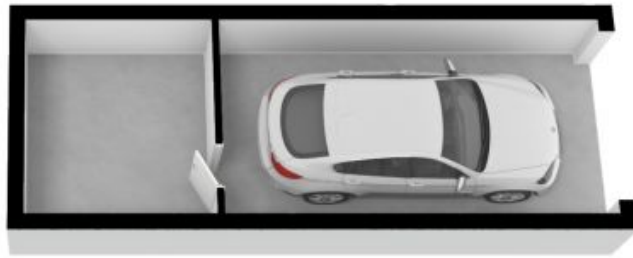

BASEMENT

The floor plan is not to scale, measurements are indicative and in metres. All features included in this 3D plan are for inspiration purposes only. This is not an exact replica of the property or the position of exterior elements. Plans should not be relied on. Interested parties should make and rely on their own enquiries.



49/88 James Ruse Drive, Rosehill



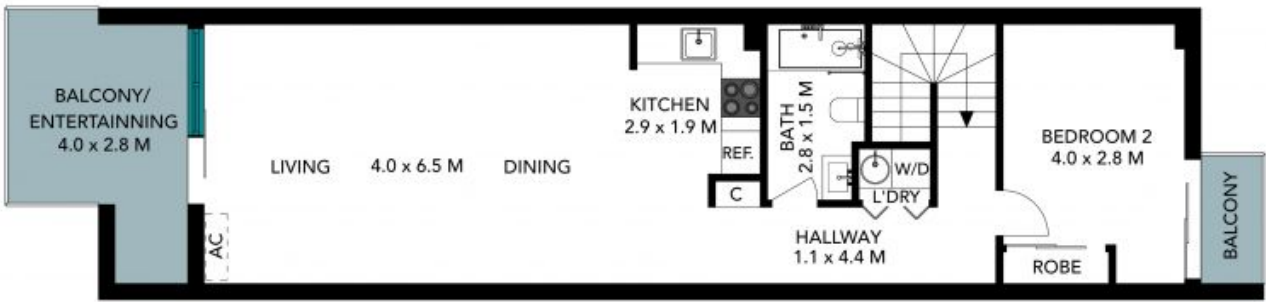

4TH FLOOR



3RD FLOOR



BASEMENT

The floor plan is not to scale, measurements are indicative and in metres. Colour elements are not to position. Plans should not be relied on. Interested parties should make and rely on their own enquiries. All other information provided has been collected from reliable sources but cannot be guaranteed for accuracy.



49/88 James Ruse Drive, Rosehill

