



6/114-120 The Promenade Sans Souci, NSW

3 

2 

2 

### Spectacular townhouse in waterfront pocket

Experience a heightened level of privacy with this uniquely designed solid brick townhouse situated to the rear of a prestigious complex on the peninsula just moments from the water's edge. Stunning interiors bathed in all-day natural light showcase a functional layout featuring sophisticated finishes throughout and superb flow to an expansive courtyard area for alfresco entertaining plus two underground car spaces. Blissfully quiet and ultra-convenient, the home is within moments of shops, parks, schools and transport, and just minutes from the beach.

Price:

SOLD \$1,370,000 | Shaun Ramani



**Shaun Ramani**

0417 444 919



**Ray Fadel**

0413 177 739

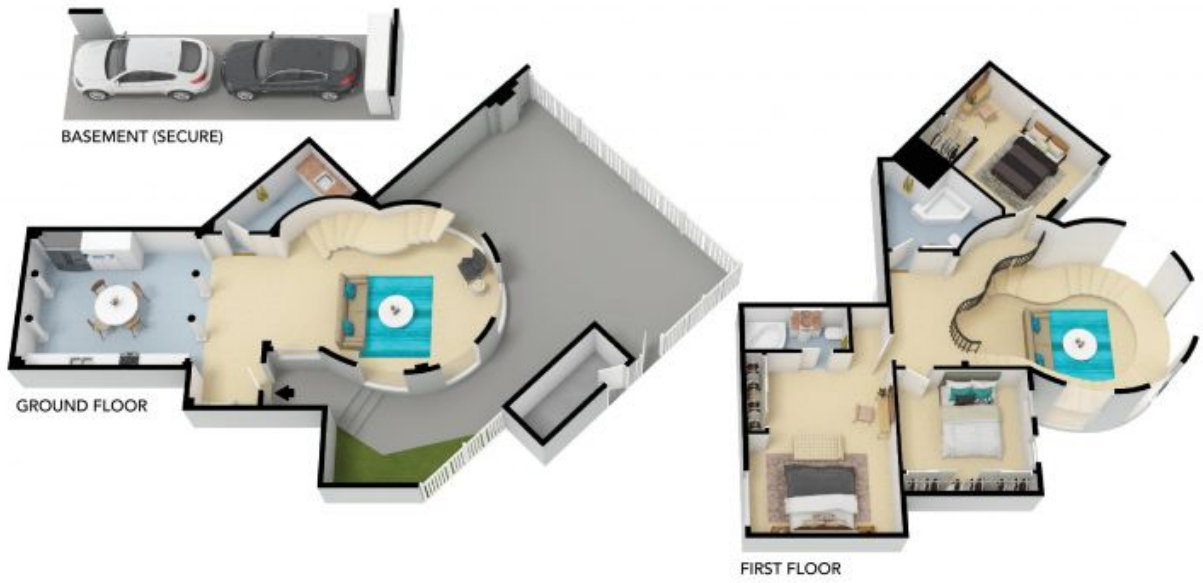

The floor plan is not to scale, measurements are indicative and in meters. All features included in this 3D plan are for inspiration purposes only. This is not an exact replica of the property or the position of exterior elements. Plans should not be relied on. Interested parties should make and rely on their own enquiries.

6/114-120 The Promenade, Sans Souci





The site plan and floor plan are not to scale; measurements are indicative and in metres. Shades and lines are placed for illustration purposes. Plans should not be relied on. Interested parties should make and rely on their own enquiries. All other information provided has been collected from reliable sources but cannot be guaranteed for accuracy.

