



4/8 Water Street Sans Souci, NSW



### Waterfront living

This luxurious two bedroom apartment captures stunning 180 degree views over the clear blue waters of the Georges River and sandy beachfront, that will never be built out. Situated within one of south Sydney's unique low-rise residential apartment complex's, this tri-level security building, built in 2005, is set along Sans Souci's peninsular, just metres away from parkland, marinas and the headland foreshore. Situated adjacent to the former Sans Souci Pavilion, the apartment boasts a gorgeous outlook over Captain Cook Bridge, Sylvania Waters, as well as Tom Ugly's Bridge, offering a truly unique opportunity to purchase a waterfront apartment.

**Price:** Contact agent  
**Council Rates:** \$361.00 p/q  
**Water Rates:** \$145.00 p/q  
**Strata Rates:** \$1,228.00 p/q



**Coleen Bowen**

0406 530 130

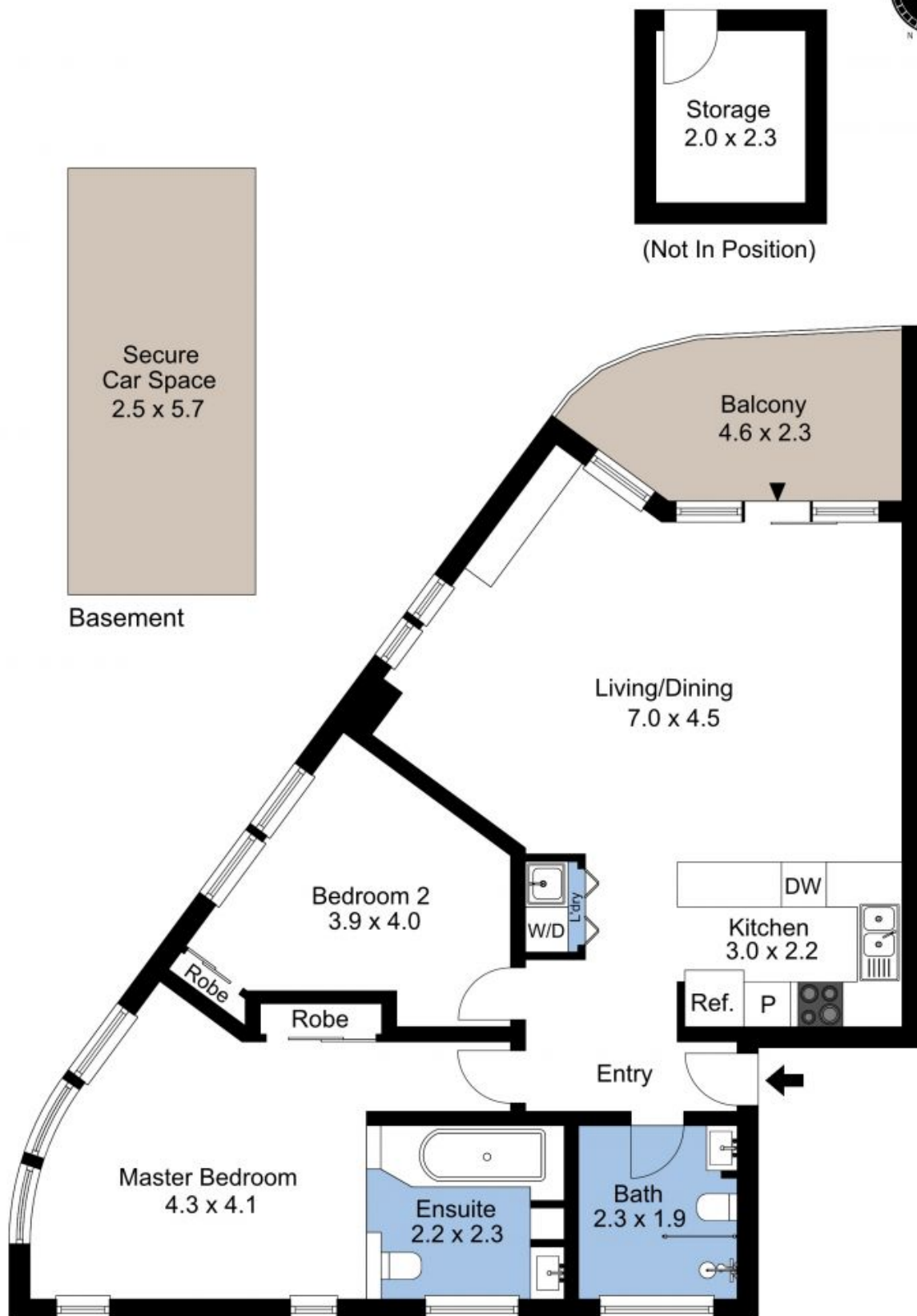

### 4/8 Water Street, Sans Souci

The floor plan is not to scale; measurements are indicative and in metres. Exterior elements are not in position. Plans should not be relied on. Interested parties should make and rely on their own enquiries.



Basement



## 4/8 Water Street, Sans Souci

The floor plan is not to scale; measurements are indicative and in metres. All features included in this 3D plan are for inspiration purposes only. This is not an exact replica of the property or the position of exterior elements. Plans should not be relied on. Interested parties should make and rely on their own enquiries.