

3/155 Queen Victoria Street Bexley, NSW

2 1 1

Easycare villa refreshed for modern living

There are not many more attractive entry points in such a great location to get started in a freshly presented home than and all this smart two-bedroom residence. Tastefully appointed and featuring many modern updates, it represents a great entry-level or scale-down opportunity and is quietly tucked away within a stroll to all of Bexley's shops, cafes and transport options.

Price: SOLD \$760,000 | Chris Kounnas
Water Rates: \$158.00 p/q
Strata Rates: \$763.00 p/q



Chris Kounnas

0412 957 575



Ray Fadel

0413 177 739

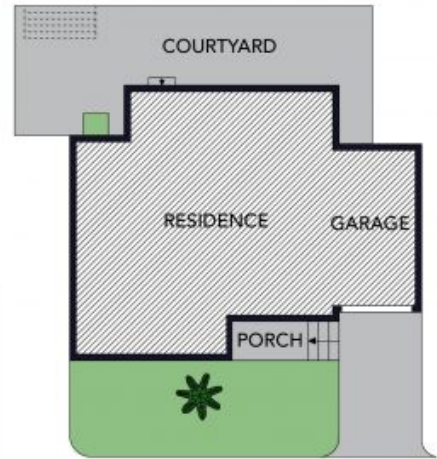

SITE PLAN



The floor plan is not to scale, measurements are indicative and in metres. Exterior elements are not in position. Plans should not be relied on. Interested parties should make and rely on their own enquiries. All other information provided has been collected from reliable sources but cannot be guaranteed for accuracy.

3/155 Queen Victoria Street, Bexley





The floor plan is not to scale, measurements are indicative and in metres. All features included in this 3D plan are for inspiration purposes only. This is not an exact replica of the property or the position of exterior elements. Plans should not be relied on. Interested parties should make and rely on their own enquiries.

3/155 Queen Victoria Street, Bexley

