



16/56-58 Gordon Street Manly Vale, NSW



North facing contemporary apartment

Offering a prized north facing aspect and a large covered terrace, this bright and airy security apartment is perfectly located in a quiet tree-lined street just minutes to Manly CBD and attractions. Local shops, supermarkets and express city buses are just steps away and Manly and Queenscliff Beaches are also easily accessible and just a short bicycle ride away.

Price: \$830,000



Eddy Piddington

0414 333 907



Michael Egan

0499 172 009

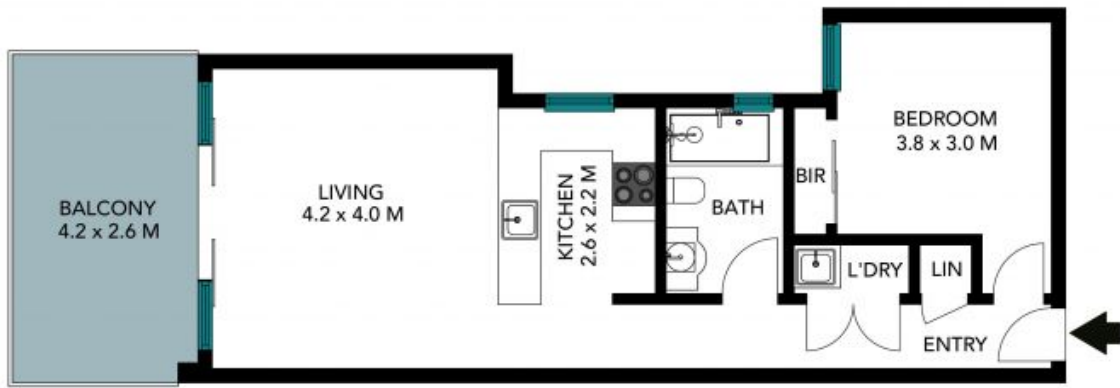

(NOT IN POSITION)

The floor plan is not to scale, measurements are indicative and in metres. Exterior elements are not in position. Plans should not be relied on. Interested parties should make and rely on their own enquiries. All other information provided has been collected from reliable sources but cannot be guaranteed for accuracy.

16/56 Gordon Street, Manly Vale





The floor plan is not to scale, measurements are indicative and in metres. All features included in this 3D plan are for inspiration purposes only. This is not an exact replica of the property or the position of exterior elements. Plans should not be relied on. Interested parties should make and rely on their own enquiries.

16/56 Gordon Street, Manly Vale

