



2 Debra Anne Drive Bateau Bay, NSW

3

1

1

Entry Level Brick & Tile

This perfect starter home is sure to be a crowd pleaser, showcasing a functional floor plan which would suit the first time buyer or savvy investor and is located in the popular suburb of Bateau Bay.

This well presented property offers three bedrooms with built-ins in to all, open plan living, dining and a fully functional kitchen with an abundance of cupboard space. Within 4kms to local schools, shops and a short drive 4.6km drive to the stunning Bateau Bay Beach and 9.5kms to the m1 motorway.

Price:

Contact Agent



Abdullah Choudhari

0401 977 187



Marc Correia

0412 460 372

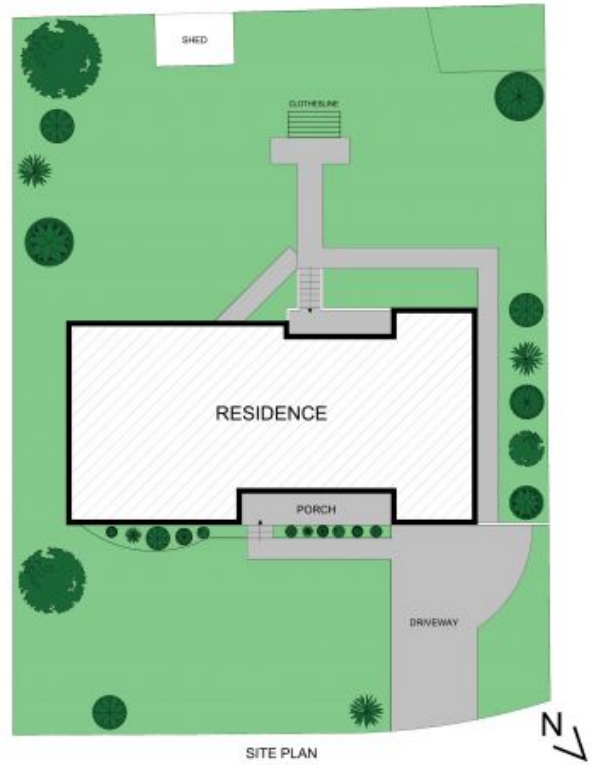

2 Debra Anne Drive, Bateau Bay

