



26 Wheatley Road Yarrawarra, NSW

3 

1 

1 

### Immaculate family home

Set across a comfortable single level floorplan, this light-filled home offers impressive space and flexibility for a growing family. Conveniently located and basking in sunlight all day it's perfect for entertaining all year round. Setting on an elevated position enjoys distant city and valley views. Moments' walk from the local primary school, oval and shops.

Price:

Contact agent



**Rhys Christofa**

0415 684 877



**Ezra Malolo**

0401 490 024



SITE PLAN



(NOT IN POSITION)

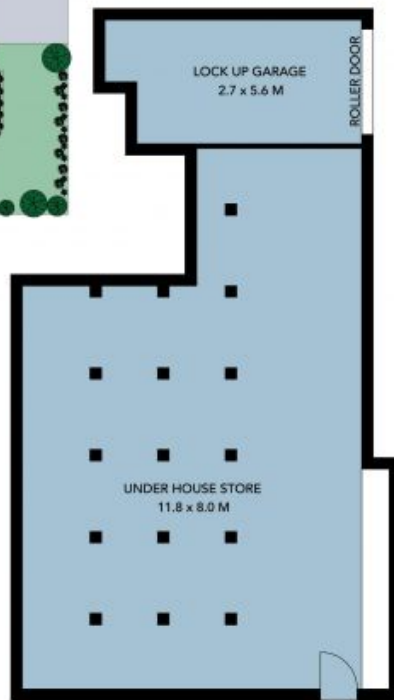

BASEMENT



GROUND FLOOR



The site plan and floor plan are not to scale, measurements are indicative and in metres. Shades and lines are placed for illustration purposes. Plans should not be relied on. Interested parties should make and rely on their own enquiries. All other information provided has been collected from reliable sources but cannot be guaranteed for accuracy.

26 Wheatley Road, Yarrawarra

STONE

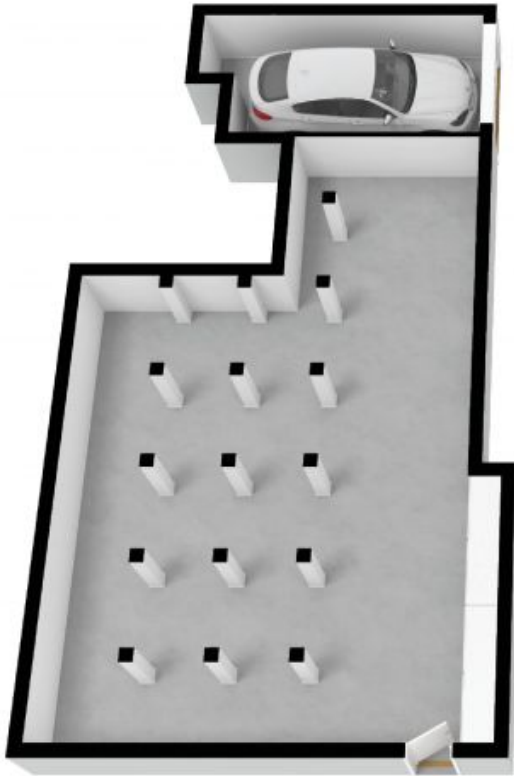

BASEMENT



GROUND FLOOR

The floor plan is not to scale, measurements are indicative and in metres. All features included in this 3D plan are for inspiration purposes only. This is not an exact replica of the property or the position of water/electrics. Plans should not be relied on. Interested parties should make and rely on their own enquiries.

26 Wheatley Road, Yarrawarra

