



214 Liverpool Road Ashfield, NSW

PRIME RETAIL OFFERING ** DEPOSIT TAKEN **

Stone Commercial, are pleased to Exclusively present for Lease this open plan, well presented Retail/Office space located within the main hub of Liverpool Road, Ashfield.

Council Rates: \$0.00 p/q
Water Rates: \$0.00 p/q
Strata Rates: \$0.00 p/q



Paul Di Mauro

0431 099 976



Rick (Riccardo) Pignetti

0439 398 959

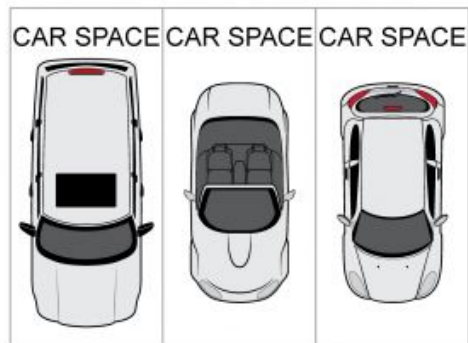
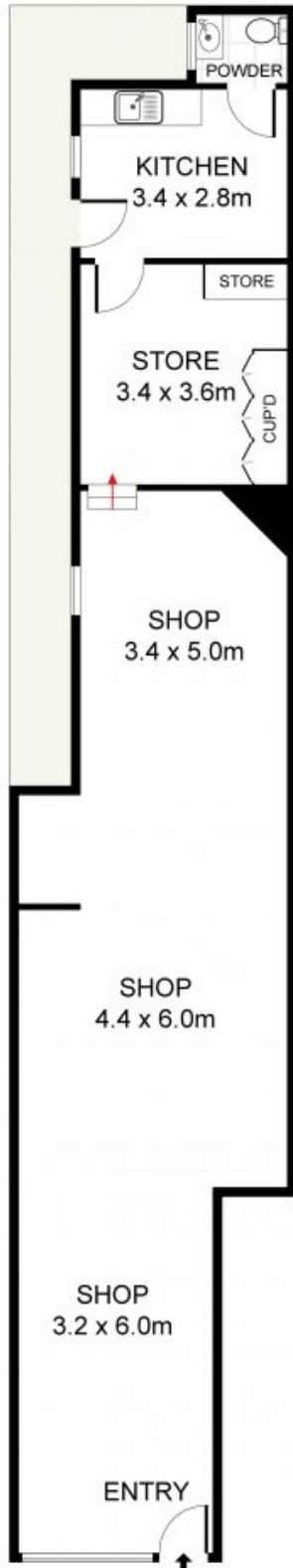

214 Liverpool Road, Ashfield



DISCLAIMER: PLANS SHOWN ARE FOR PRESENTATION PURPOSES AND ARE NOT PART OF ANY LEGAL DOCUMENT. ALL MEASUREMENTS AND FIGURES ARE APPROXIMATE.