

10 Adina Street Telopea, NSW 5 3 2

### Extended family living in Carlingford West Catchment

Peacefully positioned within an easy stroll to the upcoming Parramatta Light Rail, this stylishly updated double brick family home has been cleverly reconfigured featuring a separate two bedroom downstairs accommodation, perfect for multi-generation living.

**Price:** Deposit taken - \$850 per week  
**Available Date:** 04/09/2021



**Eliza Zammit**  
02 8893 2220



**Sarah Hastings**  
02 8893 2218



GROUND FLOOR



FIRST FLOOR

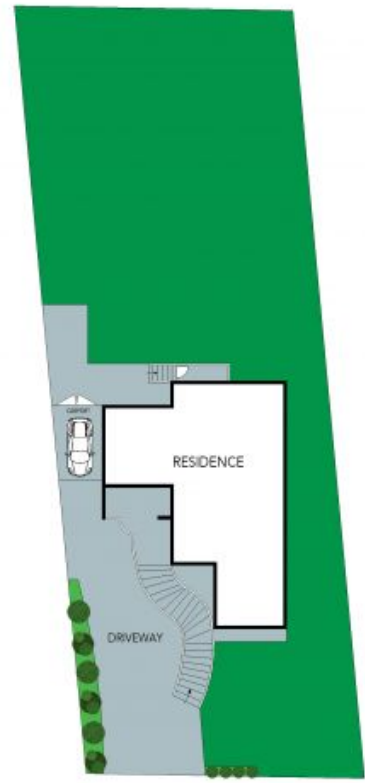

SITE PLAN

The floor plan is not to scale; measurements are indicative and in metres. Exterior elements are not in position. Plans should not be relied on. Interested parties should make and rely on their own enquiries.

10 Adina Street, Telopea

STONE

