



14/10 Darley Road Manly, NSW 2  2  1 

Gorgeous north-facing apartment in the heart of Manly

Crowning the ultra-modern 'Nautica Apartments' two floors above the pulsing heart of Manly Village, this vibrantly modern security apartment is simply brimming with extras. Remarkably bright and spacious, superbly appointed and embraced by sunny alfresco spaces with cameos of the ocean, its premier lifestyle setting is footsteps to humming eateries, the wharf and Manly Beach.

Price: \$2,500,000



Candice Cattell

0417 311 777



Laura Stenta

0404 307 166

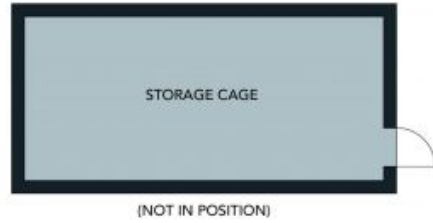
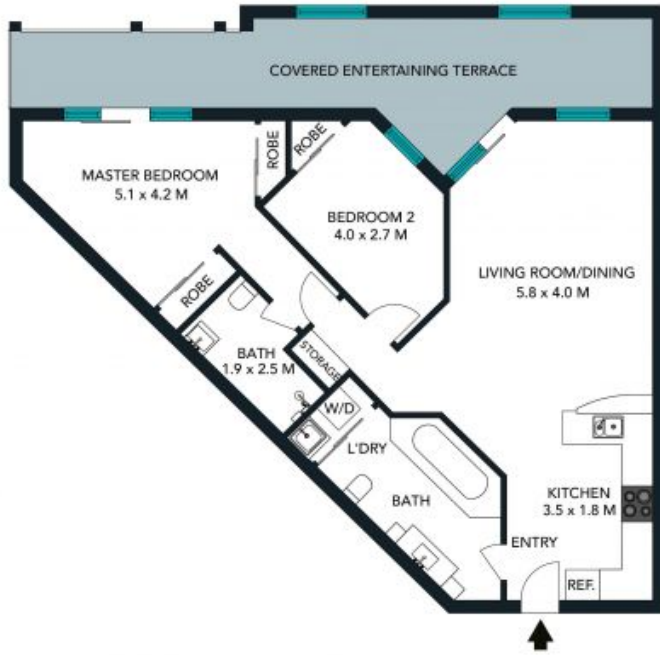

The floor plan is not to scale, measurements are indicative and in metres. Exterior elements are not in position. Plans should not be relied on. Interested parties should make and rely on their own enquiries. All other information provided has been collected from reliable sources but cannot be guaranteed for accuracy.



14/10 Darley Road, Manly





The floor plan is not to scale, measurements are indicative and in metres. All features included in this 3D plan are for inspiration purposes only. This is not an exact replica of the property or the position of exterior elements. Plans should not be relied on. Interested parties should make and rely on their own enquiries.

14/10 Darley Road, Manly

