



131A Forest Road Arncliffe, NSW 3 2 3

Mid-century style on a battle axe block

A private oasis hidden down a battle-axe block, Beachcomber is a bold, modernist home showcasing mid-century design at its best. Elevated on steel posts over a verdant lawn, the unique linear residence centres on a lengthy north-facing sundeck which captures spectacular city views over the treetops. Meticulously maintained and updated sympathetic to its provenance, the architect-designed home features copious glazing to enable a seamless indoor-outdoor flow and an uplifting sense of light and space. A short stroll to trains, shops and parklands, and just 10km to Central, this hidden gem is a unique find in a dynamic neighbourhood.

Price: \$2,000,000



Sam Abbas

0406 750 075

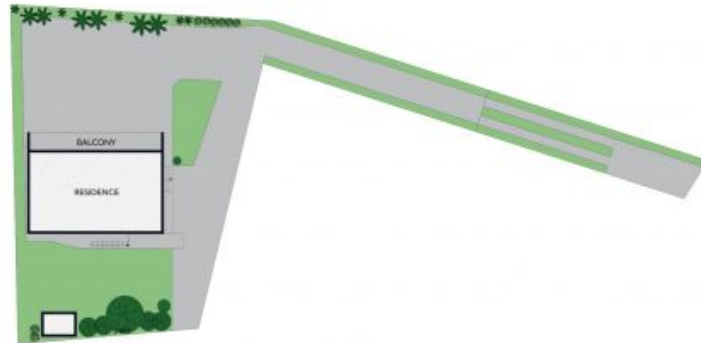

SITE PLAN



FIRST FLOOR

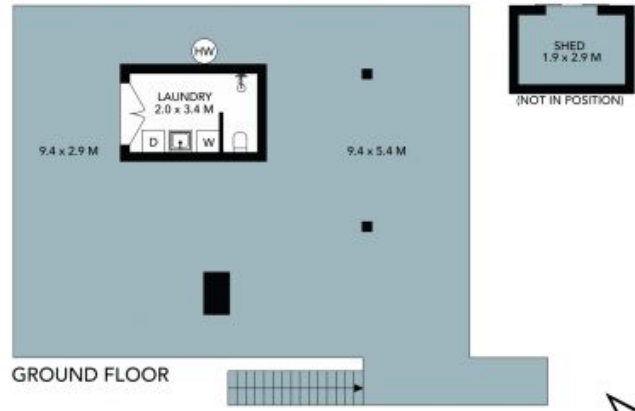

GROUND FLOOR

The site plan and floor plan are not to scale, measurements are indicative and in metres. Bushes and trees are placed for illustration purposes. Plans should not be relied on. Interested parties should make and rely on their own enquiries. All other information provided has been collected from reliable sources but cannot be guaranteed for accuracy.

131A Forest Road, Arncliffe





The floor plan is not to scale, measurements are indicative and in metres. All features included in this 3D plan are for inspiration purposes only. This is not an exact replica of the property or the position of exterior elements. Plans should not be relied on. Interested parties should make and rely on their own enquiries.

131A Forest Road, Arncliffe



STONE