



75 The Park Chase Valentine, NSW

4 2 2

Family connections surrounded by nature & the lake

Family living at its absolute best with this beautiful four bedroom home in the exclusive Valentine Gardens Estate. The whole brood has adventure and leisure on the doorstep with the lake in walking distance, bike paths to explore, and Green Point Reserve close by for picnics and bush walks. Freshly painted and carpeted, move straight in and enjoy a fabulous lifestyle for years to come.

Price: \$1,075,000



Kathleen Matinlassi

0407 244 162

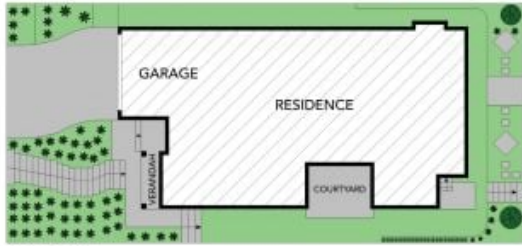

SITE PLAN



The site plan and floor plan are not to scale, measurements are indicative and in metres. Boxes and lines are placed for illustration purposes. Plans should not be relied on. Interested parties should make and rely on their own enquiries. All other information provided has been collected from reliable sources but cannot be guaranteed for accuracy.



The floor plan is not to scale, measurements are indicative and in metric. All features included in this 3D plan are for inspiration purposes only. This is not an exact replica of the property or the position of exterior elements. Plans should not be relied on. Interested parties should make and rely on their own enquiries.

75 The Park Chase, Valentine



STONE