



20/5-15 Union Street Parramatta, NSW 2  1  1 

Prime Position

This well maintained two-bedroom apartment is ideally located in the heart of Parramatta providing convenience and lifestyle at your doorstep. Presented with polished floorboards and positioned just a 7-minute walk to Parramatta station and 10 minutes to Parramatta's Eat Street & Westfield. Quick access to James Ruse Drive, Great Western Highway and a short drive to the M4 motorway.

Price:

Contact Agent



Aaron Lih

0420 825 598



Simar Gill

0410 312 242

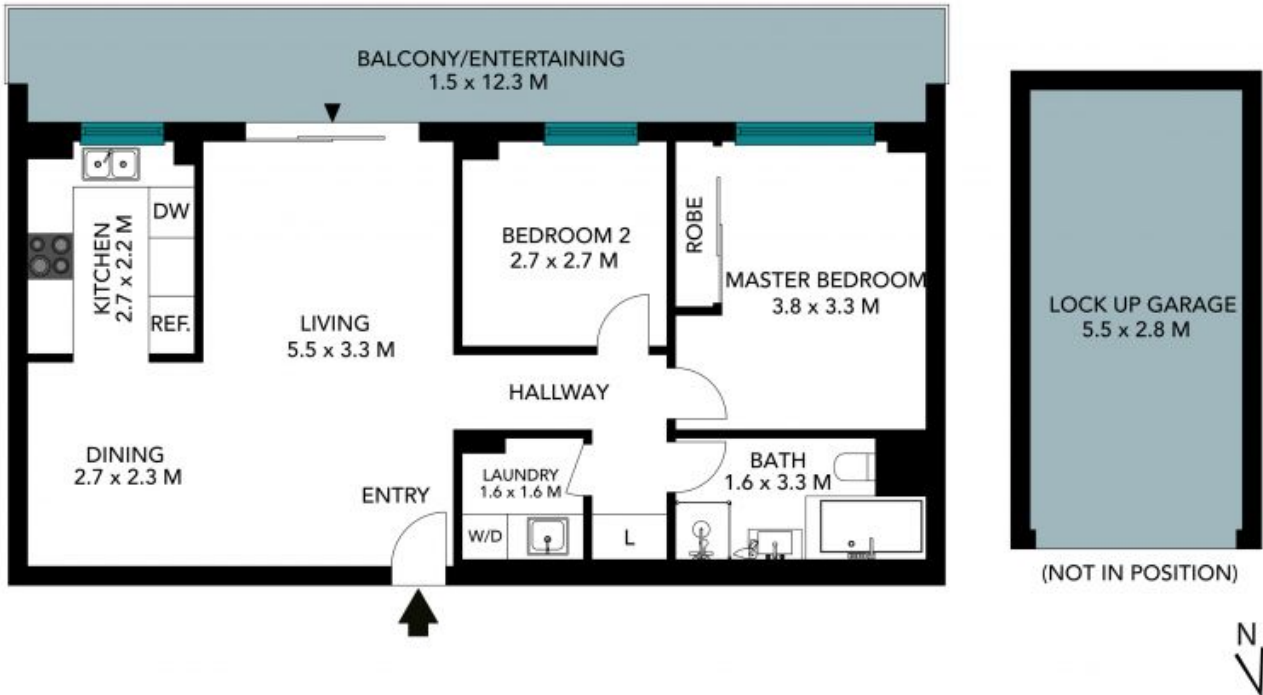

The floor plan is not to scale, measurements are indicative and in metres. Exterior elements are not in position. Plans should not be relied on. Interested parties should make and rely on their own enquiries. All other information provided has been collected from reliable sources but cannot be guaranteed for accuracy.

20/5-15 Union Street, Parramatta





The floor plan is not to scale, measurements are indicative and in metres. All features included in this 3D plan are for inspiration purposes only. This is not an exact replica of the property or the position of exterior elements. Plans should not be relied on. Interested parties should make and rely on their own enquiries.

20/5-15 Union Street, Parramatta

