



602a Rocky Point Road Sans Souci, NSW



Top floor duplex residence of modern style

With its modern design, quality finishes and generous single-level layout, this smartly appointed residence provides a superb haven in a great family location. It sits on the top floor of a duplex and offers the perfect home for those who are looking for a low-maintenance lifestyle with good proportions, a private level garden and a highly convenient location. This unique home embraces today's living with style and accessibility as it is ideally positioned strolling distance to Sans Souci's shopping hub.

Price: SOLD AT AUCTION | \$1,125,000
Council Rates: \$221.00 p/q
Water Rates: \$197.00 p/q



Shaun Ramani

0417 444 919



Yohan Ramani

0491 888 193



Site Plan



Lower Level



(NOT IN POSITION)



Upper Level



The site plan and floor plan are not to scale; measurements are indicative and in metres. Bushes and trees are placed for illustration purposes. Plans should not be relied on. Interested parties should make and rely on their own enquiries. All other information provided has been collected from reliable sources but cannot be guaranteed for accuracy.

602a Rocky Point Road
Sans Souci

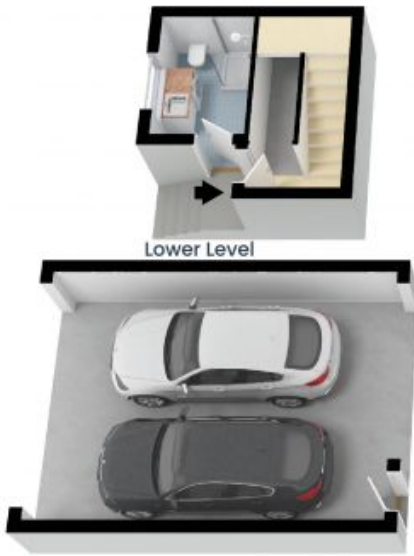

The floor plan is not to scale; measurements are indicative and in metres. All features included in this 3D plan are for inspiration purposes only. This is not an exact replica of the property or the position of exterior elements. Plans should not be relied on. Interested parties should make and rely on their own enquiries.