

1 Bidurgal Avenue Kirrawee, NSW

4 3 2

Idyllic family lifestyle in ultra-convenient location

Perfect for a large or extended family, this impeccably presented home is designed for easy modern living over two light filled levels, moments to all daily essentials. The home offers a highly functional floorplan, including optional guest or in-law accommodation on the ground floor, and is matched by a landscaped north facing garden at the rear. A haven of substance and style, it's desirably placed within walking distance of Kirrawee and Gymea shops, a choice of train stations, parks and quality schools.

Price: SOLD \$1,851,000 | Heidi Baines

Council Rates: \$520.00 p/q

Water Rates: \$197.00 p/q



Heidi Baines

0447 487 334



Ray Fadel

0413 177 739

1 Bidgural Avenue
Kirrawee



Ground Floor



First Floor

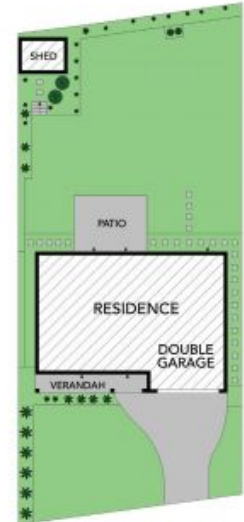

Site Plan



The site plan and floor plan are not to scale; measurements are indicative and in metres. Bushes and trees are placed for illustration purposes. Plans should not be relied on. Interested parties should make and rely on their own enquiries. All other information provided has been collected from reliable sources but cannot be guaranteed for accuracy.

1 Bidgural Avenue
Kirrawee



Ground Floor



First Floor



The floor plan is not to scale; measurements are indicative and in metres. All features included in this 3D plan are for inspiration purposes only. This is not an exact replica of the property or the position of exterior elements. Plans should not be relied on. Interested parties should make and rely on their own enquiries.