



95 Shearwater Drive Berkeley, NSW

6

3

4

Panoramic Views and Beyond

Breathtaking in the landscape with an epic rear view over Lake Illawarra, this grandly proportioned home offers an exquisite opportunity. A haven of elegance and comfort, it provides three vast living areas, a modern outdoor entertainers' design and extensive garaging with impressive workshop, storage and cellar space ? all within minutes of schools, parks and transport.

Price: \$1,315,000



Paul Piacentin

0411 754 884



Susie Bampton

0402 248 619

95 Shearwater Drive, Berkeley

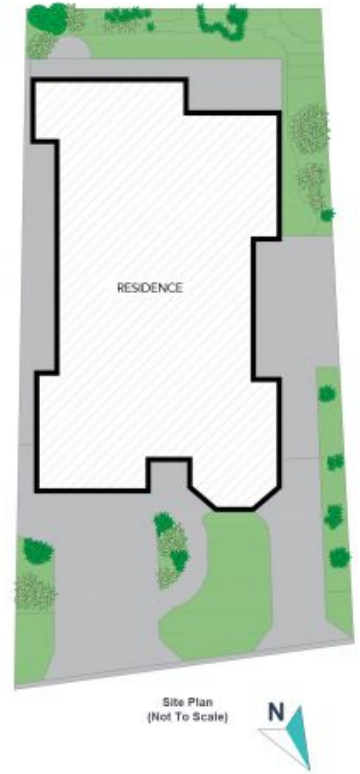

Lower Ground Floor

Ground Floor

The site plan and floor plan are not to scale; measurements are indicative and in metres. Bushes and trees are placed for illustration purposes. Plans should not be relied on. Interested parties should make and rely on their own enquiries. All other information provided has been collected from reliable sources but cannot be guaranteed for accuracy.