



41 Cobran Road Cheltenham, NSW



Pedigree architectural residence atop secluded 1088sqm parcel

An architectural feat of Bruce Rickard's iconic legacy, this modernist masterpiece embraces a deep connection to the landscape achieved by its absolutely masterful design. Perched atop an elevated 1088sqm parcel with commanding views over Lane Cove National Park's jaw-dropping landscape, the architect has maximised the perfect north-east aspect with open spaces, french doors, clerestory windows and high raked ceilings. Conveniently located within easy walk to station, this private oasis has been adored by the current owners for 24 years and is now reluctantly offered.

Price: \$2,570,000
Council Rates: \$533.00 p/q
Water Rates: \$151.00 p/q



Kevin Dearlove

0403 338 302



Chloe Mawass

0431 983 240

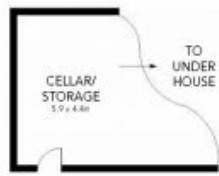

LOWER GROUND FLOOR



SITE PLAN



GROUND FLOOR

The floor plan is not to scale; measurements are indicative and in metres. Exterior elements are not in position. Plans should not be relied on. Interested parties should make and rely on their own enquiries.

41 Cobran Road, Cheltenham

Internal Area approx - 191 sqm
 External Area approx - 78 sqm
 Land Area approx - 1,088 sqm

