



10 Brentwood Place Frenchs Forest, NSW



Architect-designed oasis with stunning outlook

Quietly nestled within a family-friendly cul de sac with a perfect north-facing backyard overlooking magnificent bushland, this light-drenched and spacious architect-designed home offers an idyllic setting for family life. With a practical, free-flowing floorplan that promotes a fantastic indoor/outdoor lifestyle, this lovely home provides the perfect haven for a growing family.

Price: \$2,600,000
Council Rates: \$440.70 p/q



Chris Lewis
 0431 179 861



Chris Elliott
 0410 416 066

10 Brentwood Place
Frenchs Forest



Ground Level



1st Level



Lower Ground Level

Internal Living: 271 sqm
External Living: 42 sqm
Total Living Area: 313 sqm



The floor plan is not to scale; measurements are indicative and in metres. All features included in this 3D plan are for inspiration purposes only. This is not an exact replica of the property or the position of exterior elements. Plans should not be relied on. Interested parties should make and rely on their own enquiries.

10 Brentwood Place
Frenchs Forest



Ground Level



Lower Ground Level

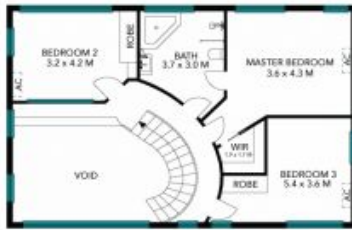

1st Level

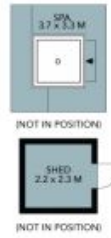

Site Plan

Internal Living: 271 sqm
External Living: 42 sqm
Total Living Area: 313 sqm



The site plan and floor plan are not to scale; measurements are indicative and in metres. Bushes and trees are placed for illustration purposes. Plans should not be relied on. Interested parties should make and rely on their own enquiries. All other information provided has been collected from reliable sources but cannot be guaranteed for accuracy.