



8 Howarth Place Chapman, ACT



### A regal and classic home enjoying abundant views over the valley

Beautifully positioned with elevated views over Woden Valley, this striking home forms the epitome of executive family living. Basking in the abundance of natural light with a north facing aspect to all front living areas, the home provides an open plan kitchen, dining and separate formal living area on the first floor. The classic kitchen sits within the centre of the home, enjoying beautiful views over the valley towards Telstra Tower and beyond.

**Price:** \$1150 per week

**Bond:** \$4,600

**Available Date:** 01/01/2022



**Amanda Tehle**

0449 065 844



**Isabella Ferry**

6253 8220



First Floor

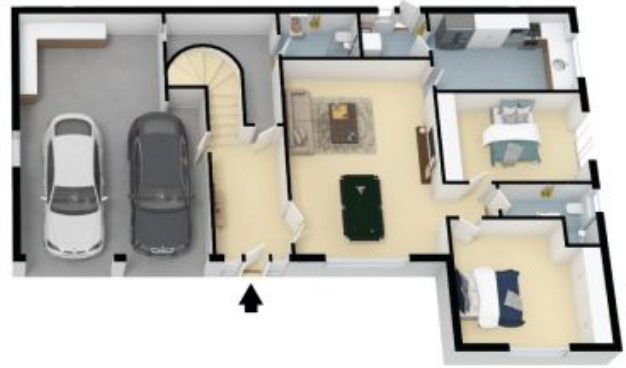

Ground Floor



The floor plan is not to scale; measurements are indicative and in metres. All features included in this 3D plan are for inspiration purposes only. This is not an exact replica of the property or the position of exterior elements. Plans should not be relied on. Interested parties should make and rely on their own enquiries.



First Floor



Ground Floor



The floor plan is not to scale; measurements are indicative and in metres. Colour elements are not in position. Plans should not be relied on. Interested parties should make and rely on their own enquiries. All other information provided has been collected from reliable sources but cannot be guaranteed for accuracy.