



404/48-52 Sydney Road Manly, NSW



Low maintenance apartment in the heart of Manly!

Private appointment only.

Price: \$655,000
Council Rates: \$366.40 p/q
Water Rates: \$157.92 p/q
Strata Rates: \$294.00 p/q



Chris Lewis

0431 179 861



Chris Lewis

0431 179 861

404/48-52 Sydney Road
Manly

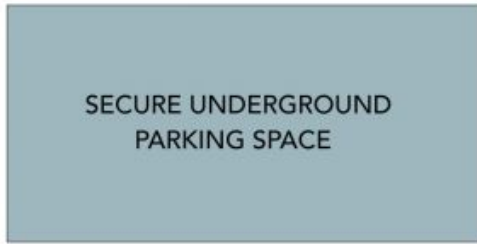

(NOT IN POSITION)

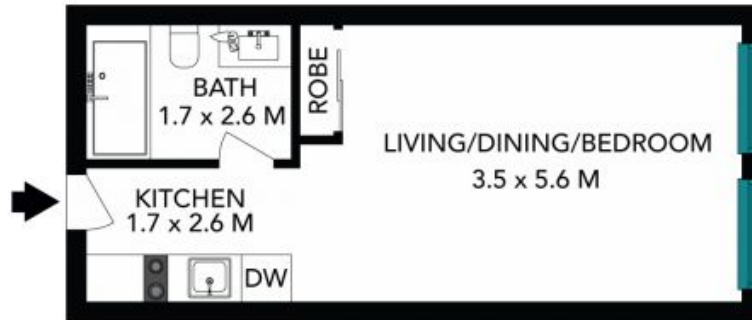

Internal Living: 29 sqm
External Living: 0 sqm
Total Living Area: 29 sqm



The floor plan is not to scale, measurements are indicative and in metres. Colour elements are not in position. Plans should not be relied on. Interested parties should make and rely on their own enquiries. All other information provided has been collected from reliable sources but cannot be guaranteed for accuracy.

404/48-52 Sydney Road
Manly

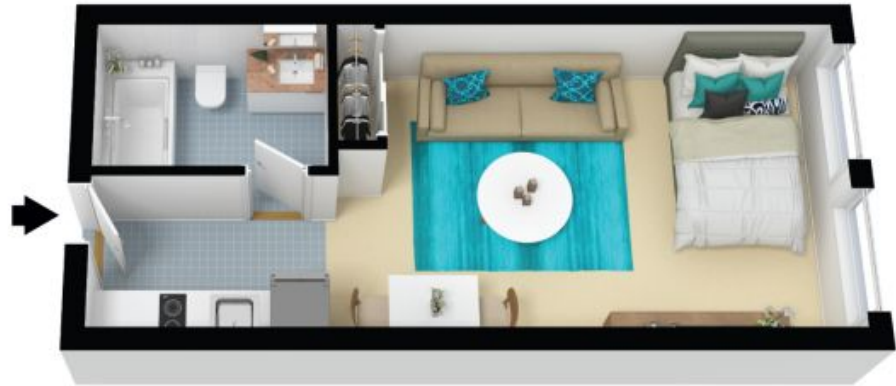

Internal Living: 29 sqm
External Living: 0 sqm
Total Living Area: 29 sqm



The floor plan is not to scale; measurements are indicative and in metres. All features included in this 3D plan are for inspiration purposes only. This is not an exact replica of the property or the position of exterior elements. Plans should not be relied on. Interested parties should make and rely on their own enquiries.