



5 Paulsgrove Street Gwynneville, NSW

3 

1 

1 

### Quaint cottage awaiting its next chapter to be written

With an abundance of cottage charm and endless potential, this circa 1960s (approx.) is ready for you to write its next chapter and create a masterpiece. Showcasing well-proportioned rooms, high ceilings and period features, you can restore the existing dwelling or knock down and start again with a blank canvas (STCA). Set in the desirable inner-city suburb of Gwynneville with easy access to the University of Wollongong, quality schools and the M1 motorway.

Price: \$1,192,000



**Sarah Ward**

0400 439 602



**Benjamin Sayers**

02 4228 1622

# 5 Paulsgrove Street Gwynneville

INT : 92m<sup>2</sup>  
EXT : 1m<sup>2</sup>  
GARAGE & WORKSHOP : 32m<sup>2</sup>

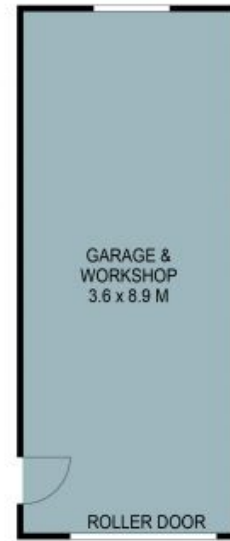
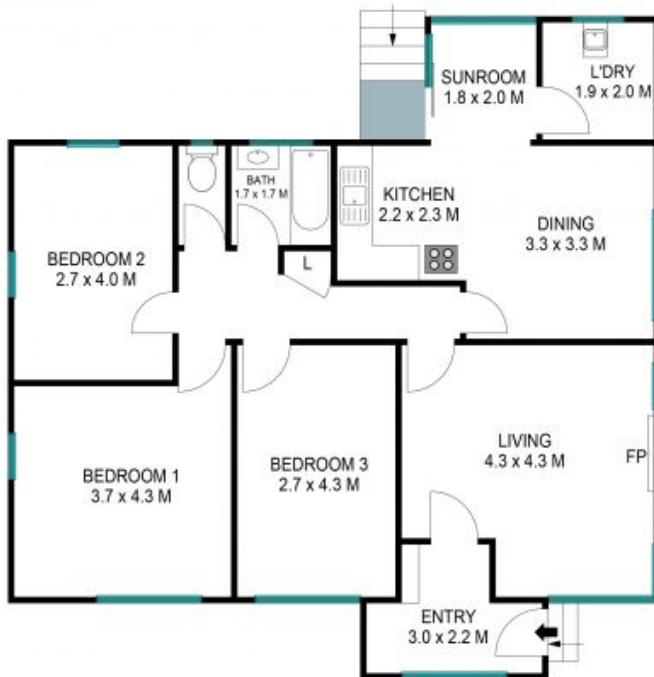

DETACHED



The site plan and floor plan are not to scale; measurements are indicative and in metres. Boundaries and lines are placed for illustration purposes. Plans should not be relied on. Interested parties should make and rely on their own enquiries. All other information provided has been collected from reliable sources but cannot be guaranteed for accuracy.