



1A Aitken Avenue Queenscliff, NSW 4 2 4

Fabulous family sanctuary opposite Manly Lagoon

Placed on 443sqm with north rear lawns screened by beautifully landscaped tropical gardens, this freestanding contemporary residence is an enchanting family haven. Designed to absolute perfection and superbly appointed throughout, it features bright open living and dining spaces flowing to private north facing terraces with a covered entertaining area.

Price:

Contact Agent



Mark Skeens

0401 241 381



Adam Moore

0428 319 096

1A Aitken Avenue
Queenscliff

STONE

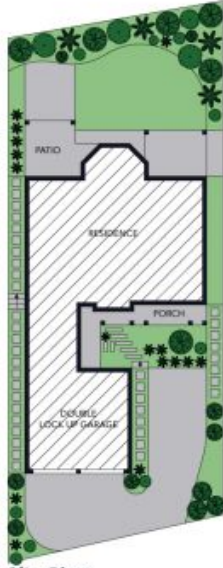

Site Plan



Ground Floor



First Floor



The site plan and floor plan are not to scale; measurements are indicative and in metres. Bushes and trees are placed for illustration purposes. Plans should not be relied on. Interested parties should make and rely on their own enquiries. All other information provided has been collected from reliable sources but cannot be guaranteed for accuracy.

1A Aitken Avenue
Queenscliff

STONE



Ground Floor



First Floor



The floor plan is not to scale; measurements are indicative and in metres. All features included in this 3D plan are for inspiration purposes only. This is not an exact replica of the property or the position of exterior elements. Plans should not be relied on. Interested parties should make and rely on their own enquiries.