

61 Wyndham Way Eleebana, NSW

4  3  2 

Family grandeur on reserve with water views

A quality dual level home featuring grand family spaces and plenty of room to grow! Large windows capture the stunning natural bush backdrop and simply beautiful Japanese gardens where there is ample room for a pool and deck with lake views. On offer for the first time, the 4-bedroom, 3-bathroom home with multiple living areas is ready for a new family to add their own touches and create treasured memories.

Price: \$1,300,000



Kathleen Matinlassi

0407 244 162

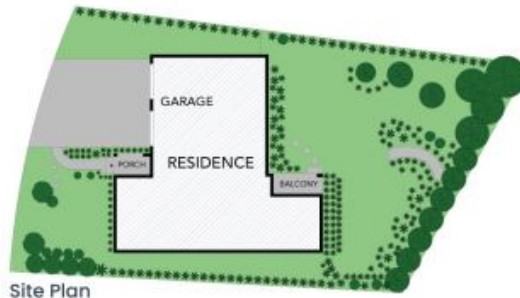

The site plan and floor plan are not to scale; measurements are indicative and in metres. Bushes and trees are placed for illustration purposes. Plans should not be relied on. Interested parties should make and rely on their own enquiries. All other information provided has been collected from reliable sources but cannot be guaranteed for accuracy.



Ground Floor



First Floor



The floor plan is not to scale; measurements are indicative and in metres. All features included in this 3D plan are for inspiration purposes only. This is not an exact replica of the property or the position of exterior elements. Plans should not be relied on. Interested parties should make and rely on their own enquiries.