



29/1 Gladstone Street Newtown, NSW      2      2      1

### Architecturally designed heritage in Newtown's iconic silo conversion

Encompassing industrial themes, this ultra-cool apartment offers a unique living space with its signature curved walls, award winning design and elevated views to the city skyline. Set within a historic flour mill conversion, it is light filled throughout and finished with many chic designer touches, plus it offers complete privacy with no common walls. It also provides a low maintenance home of excellent convenience and is tucked away behind Enmore Road within a stroll to King Street's choice of restaurants, cafes and transport options.

**Price:** Undisclosed  
**Council Rates:** \$330.00 p/q  
**Water Rates:** \$153.00 p/q  
**Strata Rates:** \$2,220.00 p/q



**Adrian Vassallo**  
0406 484 994



**Andrew Kanaway**  
0450 544 613

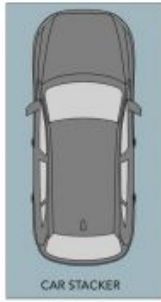

BASEMENT  
(NOT IN POSITION)

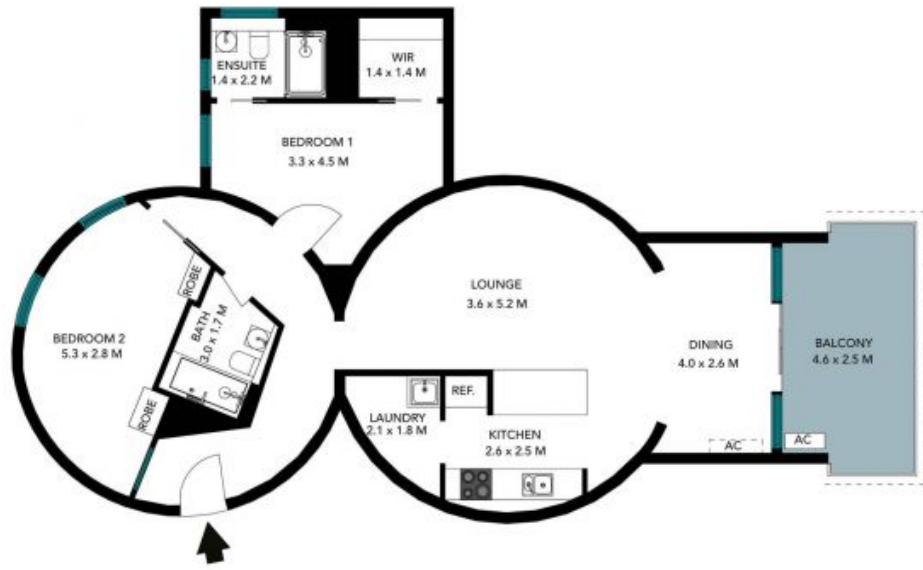

The floor plan is not to scale, measurements are indicative and in metres. Exterior elements are not in position. Plans should not be relied on. Interested parties should make and rely on their own enquiries. All other information provided has been collected from reliable sources but cannot be guaranteed for accuracy.

29/1 Gladstone Street, Newtown





The floor plan is not to scale, measurements are indicative and in metres. All features included in this 3D plan are for inspiration purposes only. This is not an exact replica of the property or the position of exterior elements. Plans should not be relied on. Interested parties should make and rely on their own enquiries.

29/1 Gladstone Street, Newtown

STONE