



52 Gordon Parade Manly, QLD

3 

2 

6 

Timeless Queenslander Elegance with dual living potential on 885m2

Inheriting a lifetime of memories over 75 years of ownership by the same family, this cherished Queenslander home is proudly offered to the market, ready for a new chapter. Beyond a picturesque character facade it presents the ultimate family haven with effortless entertaining, dual living potential, and spacious interiors draped in decadent period features.

Price: SOLD by Michelle Davies
Council Rates: \$570.24 p/q



Michelle Davies

0410 778 047



Cameron Rice

0408 885 251

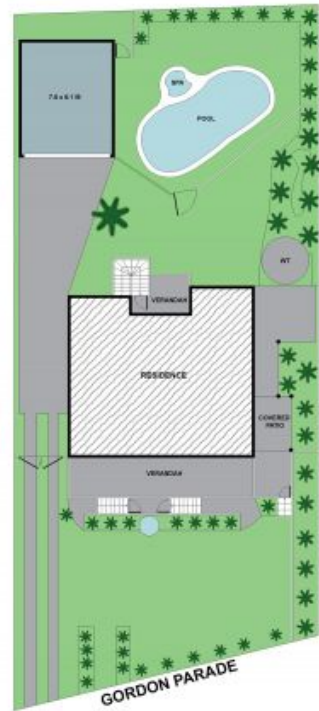

APPROX INSIDE AREA: 248.8 SQM
 APPROX OUTSIDE AREA: 116.5 SQM
 APPROX TOTAL AREA: 365.3 SQM

The site plan and floor plans are not to scale measurements are indicative and in metres. Bushes and trees are placed for illustrative purposes. Plans should not be relied on. Interested parties should make and rely on their own enquiries. All other information provided has been collected from reliable sources but cannot be guaranteed for accuracy.

52 Gordon Parade, Manly

