



2 Bromborough Road Roseville, NSW

4

2

2

High quality walk to everything home with views

Everything you could want in a family entertainer or lavish downsizer, this sensationally located walk to rail home delivers in abundance. A selection of living and entertaining areas offers innate indoor/outdoor transition, while the luxuriously appointed marble kitchen is perfect for the home cook.

Price:

Contact agent



Jill Henry

0416 493 555



Sahil Kotian

0434 172 588

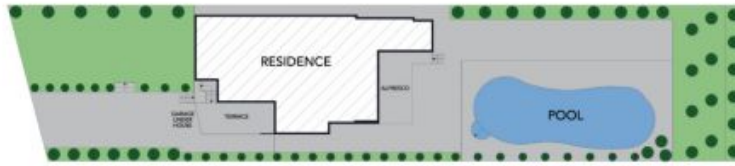

Site Plan

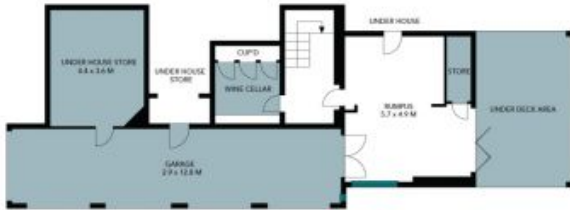

Lower Ground Level



Ground Level



The site plan and floor plan are not to scale; measurements are indicative and in metres. Bushes and trees are placed for illustration purposes. Plans should not be relied on. Interested parties should make and rely on their own enquiries. All other information provided has been collected from reliable sources but cannot be guaranteed for accuracy.

2 Bromborough Road
Roseville



Lower Ground Level



Ground Level



The floor plan is not to scale, measurements are indicative and in metres. All features included in this 3D plan are for inspiration purposes only. This is not an exact replica of the property or the position of exterior elements. Plans should not be relied on. Interested parties should make and rely on their own enquiries.