



32 Menangle Road Camden, NSW

5 3 2

Timeless Architecture

There's so much to love about living in Camden. The country lifestyle, friendly people, stunning surrounds and of course the timeless architecture. If you have always admired the homes of Camden and desired the lifestyle, then this might just be for you. This country home features a Tuscan facade originally built in the 1920's. It's positioned directly across the road from Macarthur Park and sits on approximately a large quarter acre block. It enjoys stunning leafy views to the east with plenty of yard out the back.

Price: \$1,970,000



Peter Salisbury
0457 777 517



Peter Salisbury
0457 777 517



ENTRY LEVEL



LOWER LEVEL

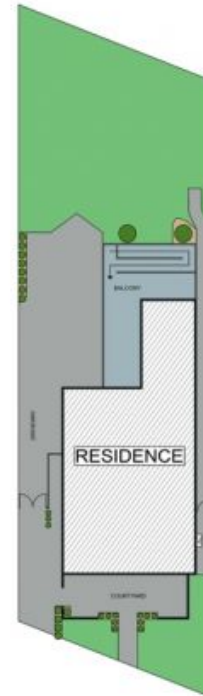

SITE PLAN



The floor plan is not to scale, measurements are indicative and in metres. Exterior elements are not in position. Plans should not be relied on. Interested parties should make and rely on their own enquiries.