

11 Mary Avenue Figtree, NSW 4  1  1 

SOLD BY STONE REAL ESTATE | SARAH WARD & JAMIE PEREIRA

Price: \$965,000

Popular cul-de-sac locale



Sarah Ward

0400 439 602



Jamie Pereira

0447 379 080

11 Mary Avenue Figtree

INT : 117m²
 EXT : 12m²
 STORAGE & L'DRY : 39m²
 GARAGE : 24m²



GROUND LEVEL

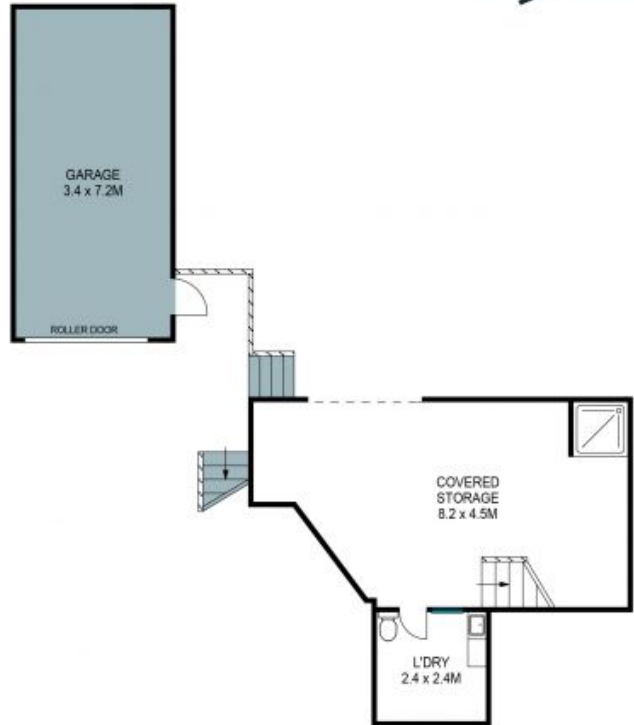

LOWER LEVEL



The site plan and floor plan are not to scale, measurements are indicative and in metres. Suries and trees are placed for illustration purposes. Plans should not be relied on. Interested parties should make and rely on their own enquiries. All other information provided has been collected from reliable sources but cannot be guaranteed for accuracy.