



186 Lakedge Avenue Berkeley Vale, NSW

6 

3 

2 

### Tall and Proud

Seeking to relocate to a convenient location on the peaceful Central Coast? Needing more space for a growing family? Look no further than this huge home opposite Tuggerah Lake sitting on the high side of the street, near some of the best beaches on the Central Coast and close to the M1. With its fantastic floor plan that encompasses multiple family living zones, this is a beautifully presented home with warmth and appealing features that any family would be proud to call their home. Boasting 6 large bedrooms, three oversized bathrooms, enormous light-filled living spaces, huge kitchen and double garage, this family haven has enough room for everyone! Outside, you'll feel like you're living in a private resort with a stunning inground pool surrounded by palm trees. You'll be captivated when you enter the upper level to the two large light filled living areas which open out onto an expansive north facing deck capturing the morning sun or the afternoon breeze off the lake. Adjoining the living areas is a very big kitchen ensuring that the whole space is perfect when the family want to spend time together. When everyone wants to retreat to their own space, the upper level has a grand sized master bedroom with double built-ins and one of the largest ensuite bathrooms you will ever see! Two more good sized bedrooms with built-ins and another large bathroom are on this level. Downstairs are three more bedrooms with built-ins, any of which could double as a study or home office for working from home, and another bathroom. This level provides the privacy that teenagers seek but

Price: \$1,120,000



**Volkan Akintetik**

0499 830 247



**Reece Caira**

0431 013 342

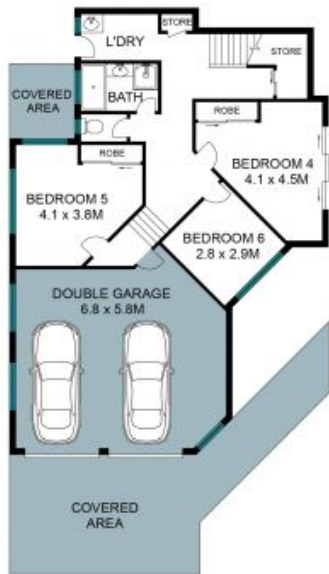

GROUND FLOOR



FIRST FLOOR



SITE PLAN

The site plan and floor plan are not to scale, measurements are indicative in metres. Bushes and trees are placed for illustration purposes. Plans should not be relied on. Interested parties should make and rely on their own inquiries. All other information provided has been collected from reliable sources but cannot be guaranteed for accuracy.



186 Lakedge Avenue, Berkeley Vale

