



11/31 Addison Road Manly, NSW



### Extraordinary penthouse offered for the first time in over 50 years

From its bright and spacious interiors and glistening yacht-sprinkled harbour views to its enormous entertainers' terrace and extra-wide balcony, this extraordinary apartment offers the perfect ensemble from which to fashion a modern day masterpiece. Boasting the penthouse position atop an immaculate security building of only 11 with level enclosed lawn and a terrace with a sparkling pool, its tranquil setting is a short stroll from beaches, the city ferry terminal and Manly's cosmopolitan cuisine and social scene.

Price:

Contact Agent



**Tim Mumford**

0421 942 693



**Kathryn 'Charlie'**

0447 664 302

**Delaney**



The floor plan is not to scale; measurements are indicative and in metres. Exterior elements are not in position. Plans should not be relied on. Interested parties should make and rely on their own enquiries. All other information provided has been collected from reliable sources but cannot be guaranteed for accuracy.

11/31 Addison Road  
Manly

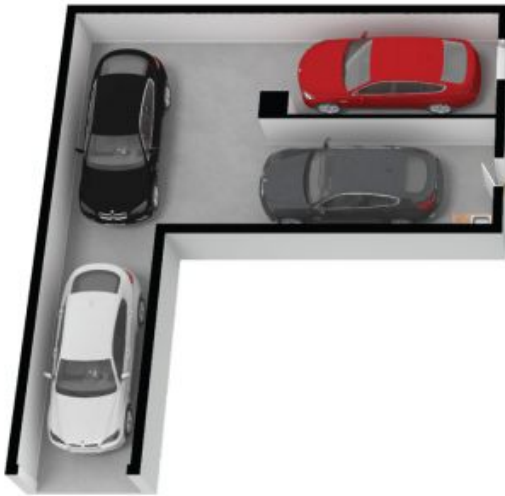

The floor plan is not to scale, measurements are indicative and in metres. All features included in this 3D plan are for inspiration purposes only. This is not an exact replica of the property or the position of exterior elements. Plans should not be relied on. Interested parties should make and rely on their own enquiries.