



10 Rodney Avenue Beecroft, NSW

4

3

3

### Sold in 34 Days

Sensational family proportions, heavenly outdoor entertaining and an elevated position capturing bird's-eye district views atop 752.5sqm land are all magnificent features of this lifestyle home. Its expansive Merbau timber deck, heated saltwater pool and adjoining level lawns make for a rare environment that fulfils every family desire, paired with freshly modernised interiors for both a picturesque escape and ultra-convenient home - zoned for WPH Public, Cheltenham Girls and Carlingford High.

**Price:** Sold in 34 Days

**Council Rates:** \$548.00 p/q

**Water Rates:** \$150.00 p/q



**Kevin Dearlove**

0403 338 302



**Jeff Jianfu Luo**

0425 286 668

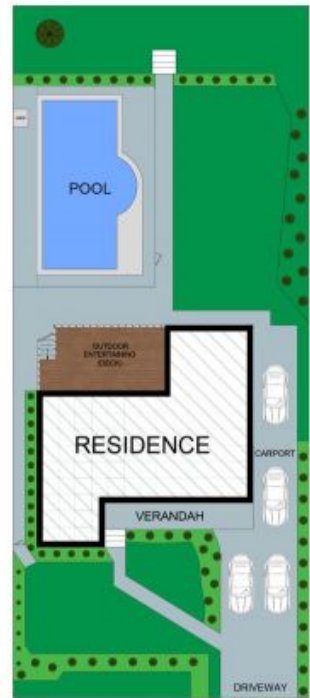

The floor plan is not to scale; measurements are indicative and in metres. Exterior elements are not in position. Plans should not be relied on. Interested parties should make and rely on their own enquiries.



10 Rodney Avenue, Beecroft

Internal Area Approx. - 176 sqm  
 External Area Approx. - 576.5 sqm  
 Land Area Approx. - 752.5 sqm

