



24 Hebburn Street Pelaw Main, NSW

3 1 1

Well loved 3 bedroom home ready for an update

A lovingly cared for near north facing haven for those wanting close proximity to shops, cafes and an easy 3km to the expressway. While quite livable as is you could really maximize the potential here with just a few minor updates. . Featuring 3 good sized bedrooms, separate living/dining and ultra versatile rear lane access. All on a near level and fenced block, with carport and work shed.

Price: \$540,000



Renee Bean-Wyper

0403 325 076



Tenesha Cullen

0416 238 158

24 Hebburn Street
Pelaw Main



The floor plan is not to scale; measurements are indicative and in metres. All features included in this 3D plan are for inspiration purposes only. This is not an exact replica of the property or the position of exterior elements. Plans should not be relied on. Interested parties should make and rely on their own enquiries.

24 Hebburn Street
Pelaw Main

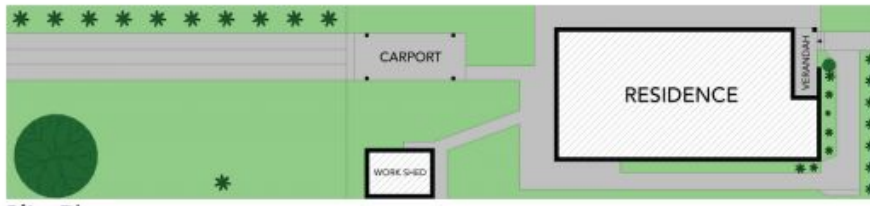

Site Plan



(NOT IN POSITION)



(NOT IN POSITION)

The site plan and floor plan are not to scale; measurements are indicative and in metres. Bushes and trees are placed for illustration purposes. Plans should not be relied on. Interested parties should make and rely on their own enquiries. All other information provided has been collected from reliable sources but cannot be guaranteed for accuracy.