



1124 Grose Vale Road Kurrajong, NSW



Prime Location!

This character filled home is perfectly situated in a prime location in the Kurrajong village. It boasts a warm welcome with a pretty streetscape including established hedges, front verandah and a leadlight front door.

Price:

SOLD BY CATHY WALTON



Cathy Walton

0400 220 355

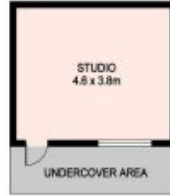

1124 GROSE VALE RD, KURRAJONG

DISCLAIMER:
PLANS SHOWN ARE FOR MARKETING PURPOSES ONLY. ALL DIMENSIONS ARE APPROXIMATE AND NOT TO SCALE. THEY ARE SUBJECT TO SURVEY AND INQUIRIES. AND NO LIABILITY WILL BE ACCEPTED. INTERESTED PARTIES SHOULD MAKE THEIR OWN INQUIRIES.

