

22 Porpoise Crescent Bligh Park, NSW

3 1 2

Superbly renovated home

Adam Buchert and Luke O'Hare are proud to present this superbly renovated home nestled in the heart of Bligh Park. Situated on a generous 623 square meters this generous family home is conveniently located within walking distance of local shops and schools. In addition, the neighborhood of Bligh Park is situated on the threshold of the Windsor Downs nature reserve with an abundance of scenic walking trails. This updated home includes all the features necessary to impress.

Price: \$907,500



Adam Buchert
0488 717 184



Luke O'Hare
0458 000 808

22 Porpoise Crescent
Bligh Park



The floor plan is not to scale; measurements are indicative and in metres. All features included in this 3D plan are for inspiration purposes only. This is not an exact replica of the property or the position of exterior elements. Plans should not be relied on. Interested parties should make and rely on their own enquiries.

22 Porpoise Crescent
Bligh Park

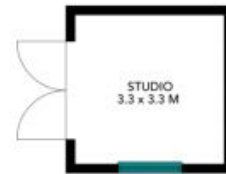

(NOT IN POSITION)



(NOT IN POSITION)



The floor plan is not to scale, measurements are indicative and in metres. Exterior elements are not in position. Plans should not be relied on, interested parties should make and rely on their own enquiries. All other information provided has been collected from reliable sources but cannot be guaranteed for accuracy.