



Level 1206a/22 Dorcas Street South Melbourne, VIC



### Stylish apartment at 'The Elm'

This beautiful 1 bedroom apartment in the stylish 'ELM' complex has so much to offer!

**Price:** \$360 pw  
**Bond:** \$1,564  
**Available Date:** 08/08/2022



**Jessica Conte-Singh**  
0400 134 550



**Alysha Clayton**  
0417 669 287

1206A/ 22 Dorcas St  
South Melbourne



The floor plan is not to scale; measurements are indicative and in metres. All features included in this 3D plan are for inspiration purposes only. This is not an exact replica of the property or the position of exterior elements. Plans should not be relied on. Interested parties should make and rely on their own enquiries.

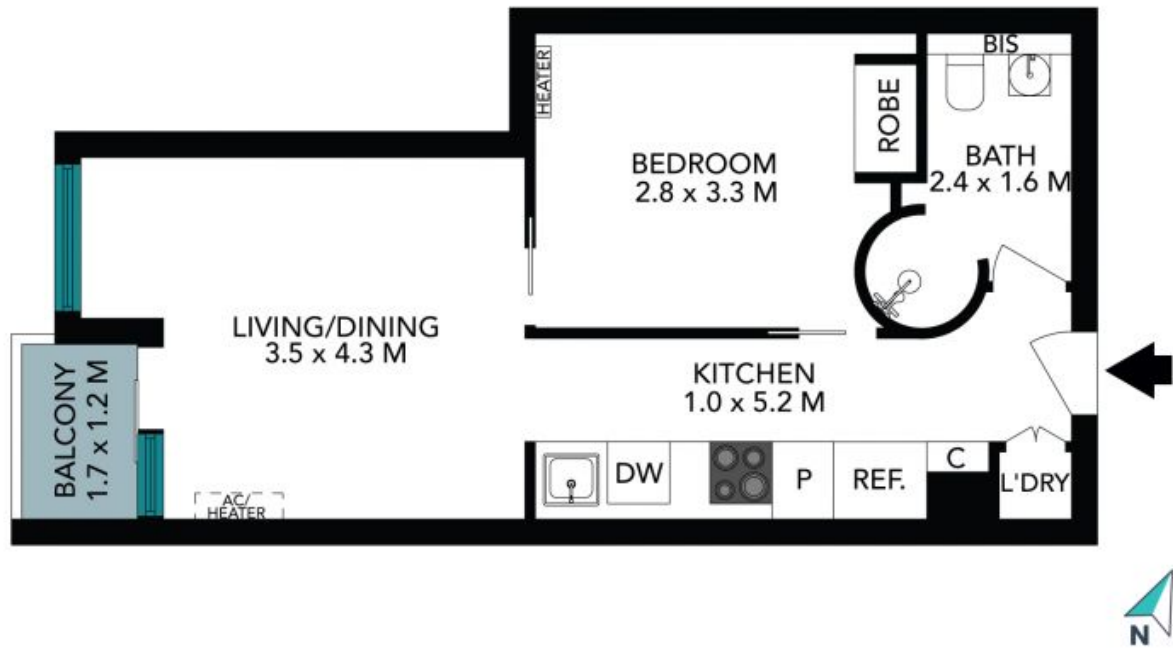

The floor plan is not to scale; measurements are indicative and in metres. Entrance elements are not in position. Plans should not be relied on. Interested parties should make and rely on their own enquiries. All other information provided has been collected from reliable sources but cannot be guaranteed for accuracy.