

6 Esperance Place Yarrawarrah, NSW



Stunning bush views in family-friendly location

This beautifully appointed home offers contemporary family living paired with resort-like inclusions in a quiet bush cul-de-sac. A rare opportunity, it blends generous proportions with multiple indoor and outdoor areas, boasting an alluring environment to live, relax and entertain. Its serene setting is moments from bushwalking tracks, shops and transport, making it a superb lifestyle choice.

Price: \$1,785,000
Council Rates: \$449.10 p/q
Water Rates: \$339.06 p/q



Rhys Christofa

0415 684 877



Lisa Hale

0417 418 250

6 Esperance Place
Yarrawarra



The site plan and floor plan are not to scale; measurements are indicative and in metres. Bushes and trees are placed for illustration purposes. Plans should not be relied on. Interested parties should make and rely on their own enquiries. All other information provided has been collected from reliable sources but cannot be guaranteed for accuracy.

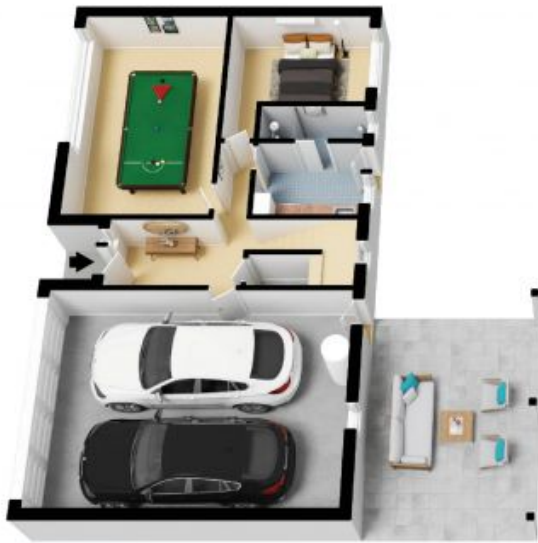

Ground Floor



First Floor



The floor plan is not to scale; measurements are indicative and in metres. All features included in this 3D plan are for inspiration purposes only. This is not an exact replica of the property or the position of exterior elements. Plans should not be relied on. Interested parties should make and rely on their own enquiries.