



B1/3-11 Burleigh Street Lindfield, NSW

2 1 2 1

Generously proportioned 2 bedroom garden apartment

This stunning light filled modern apartment features an open plan design with a large private courtyard garden.

Price: Deposit Taken
Available Date: 19/08/2022



Max Ma
0468 398 868



Stephanie Ryan
0451 307 760



BASEMENT LEVEL
(NOT IN POSITION)

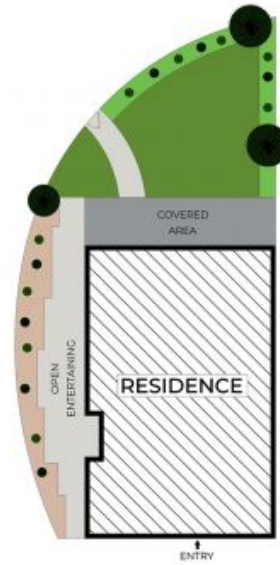

The site plan and floorplan are not to scale, measurements are indicative in meters. Bushes and trees are placed for illustration purposes. Plans should not be relied on, interested parties should make and rely on their own inquiries. All other information provided has been collected from reliable sources but cannot be guaranteed for accuracy.

B1/3-11 Burleigh Street, Lindfield

