



36 Chelmsford Avenue Epping, NSW



Peaceful period sanctuary in esteemed locale, elite schooling address

A seamless harmony of Federation heritage and true contemporary ease, 'Moolawah' c1920 is a beautifully refined home in an exclusive pocket of Epping. Decorative plasterwork, leadlights and kauri pine floors adorn its original front interiors, while the rear benefits from a luxe renovation resulting in open plan alfresco comfort. Set on the high side upon a 765sqm north facing block, this quiet family residence is located a walk from Epping shops and transport, with coveted access to Cheltenham Girls, Epping Boys, Carlingford High and the soon-to-be-built Chelmsford Avenue primary.

Price: Auction
Council Rates: \$682.00 p/q
Water Rates: \$181.00 p/q



Kevin Dearlove

0403 338 302



Jeff Jianfu Luo

0425 286 668

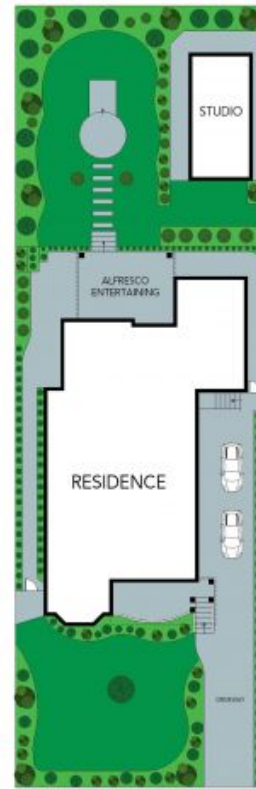

SITE PLAN

The floor plan is not to scale; measurements are indicative and in metres. Exterior elements are not in position. Plans should not be relied on. Interested parties should make and rely on their own enquiries.

36 Chelmsford Avenue, Epping

Internal Area approx - 160 sqm
 External Area approx - 58 sqm
 Land Area approx - 765.1 sqm

