



1 Cedrela Crescent Bray Park, QLD

3 

2 

2 

3 Bedroom Family Home

- * 3 Bedrooms
- * 2 Bathrooms
- * 2 Car Garage
- * Side Access

Price:

Sold For \$650,000



Sue Ward

0427 073 434



UPPER FLOOR

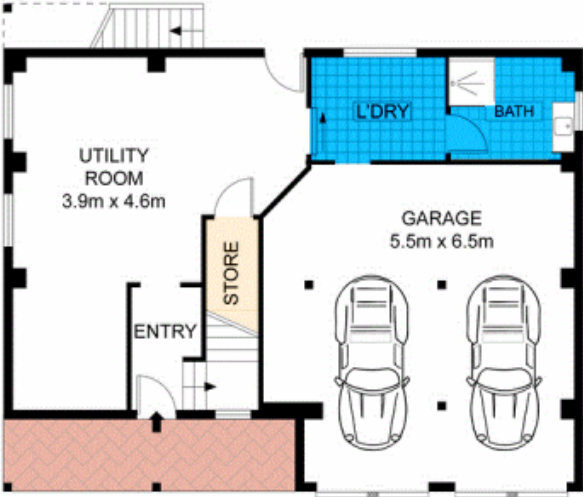

LOWER FLOOR



(Floor Plan For Illustrative Purposes Only)
Scale in metres. We give no guarantee, warranty or representation as to the accuracy and completeness of the floor plan. We recommend that you instruct your own surveyor to carry out an independent investigation of the property prior to relying on the accuracy and completeness of this plan. Floorplan created by Open2view www.open2view.com

APPROXIMATE AREAS
TOTAL: 180m²

1 Cedrela Crescent, Bray Park