



23 Shakespeare Parade Strathpine, QLD

3 

1 

2 

NEW KITCHEN PLUS MASSIVE RUMPUS

This 3 bedroom full brick home with an internal staircase - offers a range of options for buyers to make this home their own. It has massive potential, especially the downstairs area with its over sized rumpus room and larger than normal double garage space. Upstairs has a brand new kitchen with appliances. The stunning timber floors provide a classic look that every one loves and makes home feel warm and inviting.

This home offers so much potential with room for a double carport on the front and a large covered deck off the back that would over look the beautiful trees and reserve. The back yard with its mature trees, provides great shady yard for the kids to play.

Price:

Sold for \$430,000



John Ward

0427 090 968

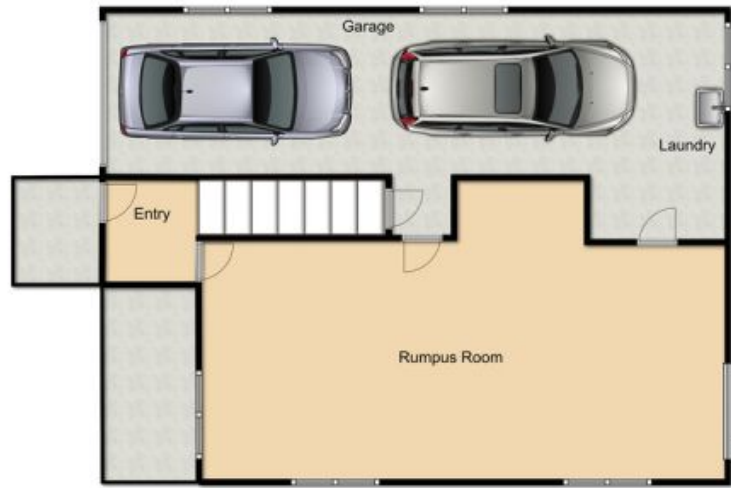

GROUND FLOOR



FIRST FLOOR

Whilst every attempt has been made to ensure accuracy, Floorplans are representative & should be used as a guide only.

ONE AGENCY



41m

15m

LAND SIZE: 607sqm

15m

Shakespeare Road

41m

Property lines are indicative only