

67 Victoria Road Rozelle, NSW

ULTRA MODERN SHOWROOM, CORNER EXPOSURE !!

Stone Commercial, are pleased to exclusively present 67 Victoria Road, Rozelle, a property of this calibre is rarely offered. Positioned on a commanding corner of Victoria Road, & Joseph St, the property offers approximately 220* sqm of Land.

Council Rates: \$0.00 p/q
Water Rates: \$0.00 p/q
Strata Rates: \$0.00 p/q



Paul Di Mauro

0431 099 976



Rick (Riccardo) Pignetti

0439 398 959

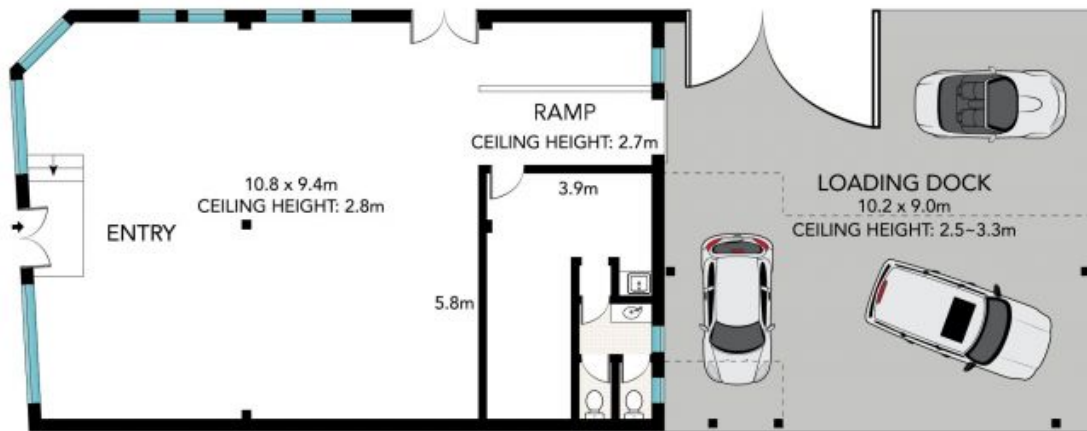

67 Victoria Road, Rozelle



All information in this document has been gathered from various third party sources we believe to be reliable; however, we cannot guarantee its accuracy, and we accept no responsibility and disclaim all liability in respect to any errors, omissions, inaccuracies or misstatements in this document. Prospective purchasers are advised to carry out their own investigations and rely on their own enquiries.