



33 Abuklea Road Epping, NSW



Double brick family home in prestigious east side locale

Cherished within the same family for over half a century, this heartwarming residence promises an extraordinary sense of space and serenity that must be seen to be fully appreciated. This full brick home is positioned to capture breathtaking green vistas over neighbouring Terry's Creek reserve, with leafy aspects that permeate its tastefully transformed, sun-kissed interiors. Occupying 790.4sqm in Epping's prized east, it's zoned for Epping Primary, Cheltenham Girls, Epping Boys and Carlingford High.

Price: Contact Agent
Council Rates: \$640.30 p/q
Water Rates: \$149.35 p/q



Kevin Dearlove

0403 338 302



Jeff Jianfu Luo

0425 286 668

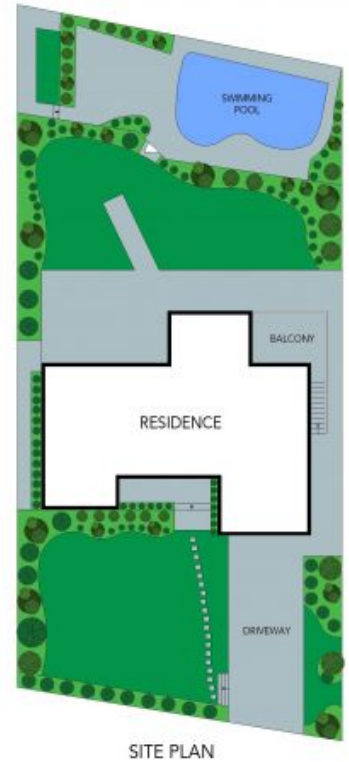

The floor plan is not to scale; measurements are indicative and in metres. Exterior elements are not in position. Plans should not be relied on. Interested parties should make and rely on their own enquiries.

33 Abuklea Road, Epping

Internal Area approx - 268 sqm
 External Area approx - 15 sqm
 Land Area approx - 790.4 sqm

