

402/40-48 Atchison Street St Leonards, NSW

2 1 2 1

SOLD BY CHRIS REYNOLDS

Conveniently located between St Leonards Station, Crows Nest shopping village, & the future Crows Nest Metro Station, this spacious apartment in the renowned "Arden" building also boasts a decent sized separate study with its own window.

Price: Auction - Contact Agent
Council Rates: \$293.00 p/q
Water Rates: \$166.82 p/q
Strata Rates: \$1,834.87 p/q



Chris Reynolds

0416 265 967



Chris Reynolds

0416 265 967

402/40-48 Atchison Street
St Leonards

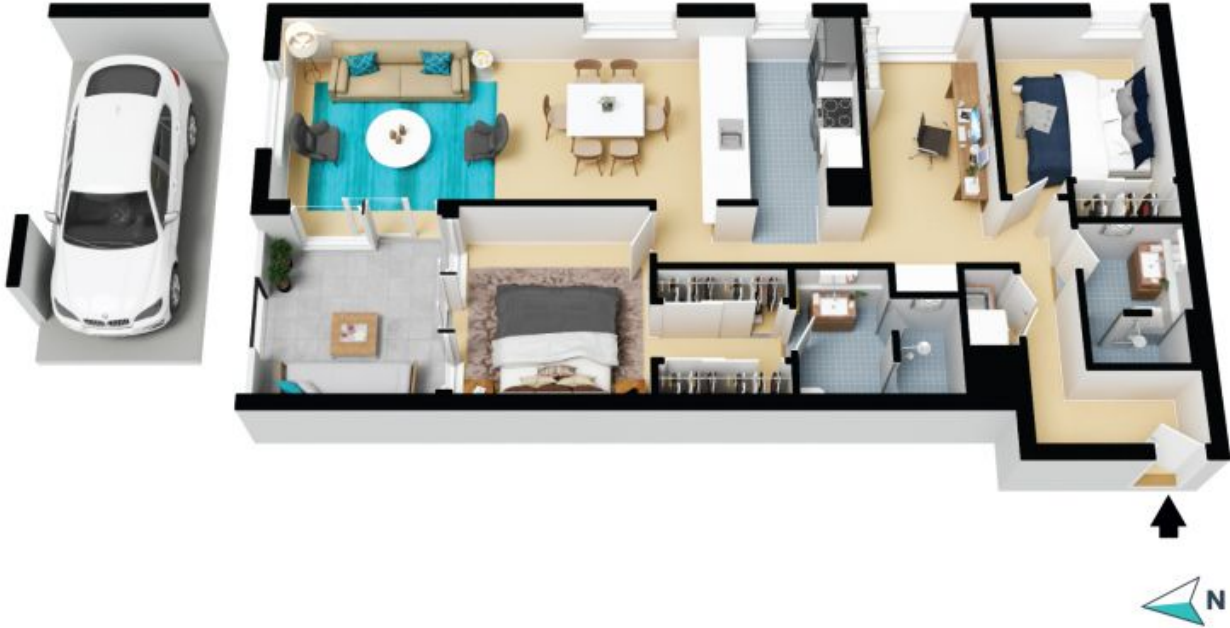

The floor plan is not to scale; measurements are indicative and in metres. All features included in this 3D plan are for inspiration purposes only. This is not an exact replica of the property or the position of exterior elements. Plans should not be relied on. Interested parties should make and rely on their own enquiries.

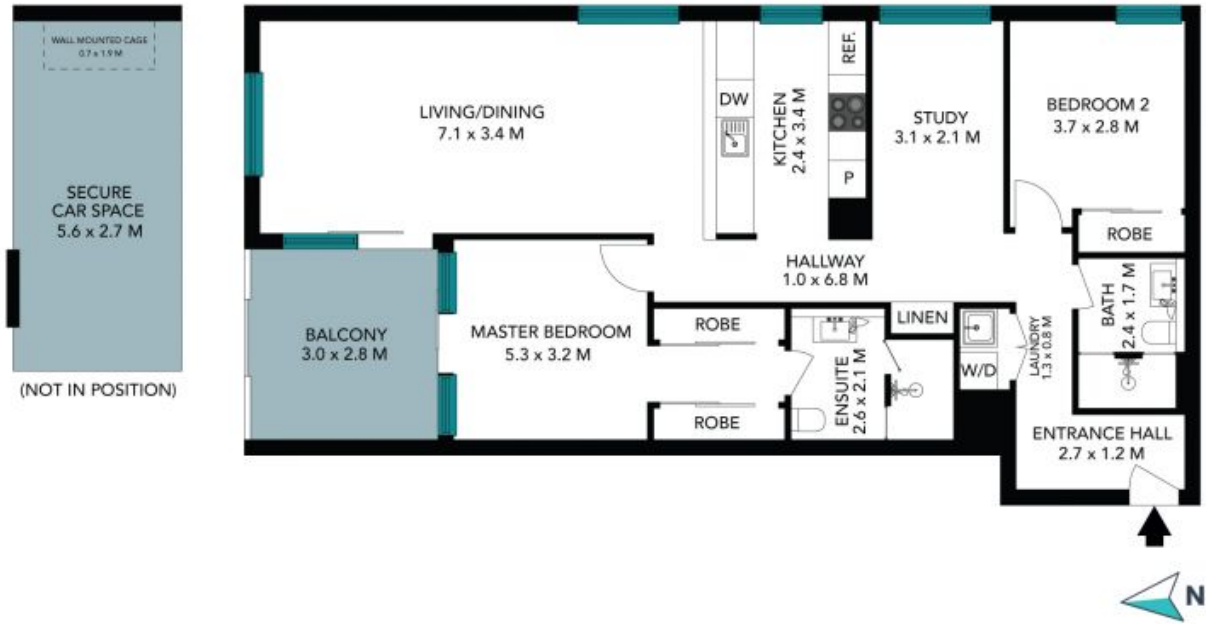

This floor plan is not to scale; measurements are indicative and in metres. Exterior elements are not in position. Plans should not be relied on. Interested parties should make and rely on their own enquiries. All other information provided has been collected from reliable sources but cannot be guaranteed for accuracy.