

6/190 Sydney Road Fairlight, NSW 4 2 2

Lifestyle, convenience and low maintenance living

Private and spacious, this dual level town home offers a super-convenient location and low maintenance living with a lifestyle address. The highly practical floorplan features an open plan design over two levels with an abundance of space and privacy. Adding to the home's appeal are the multiple outdoor spaces including a peaceful oversized courtyard, covered terrace and spacious upper balcony.

Price: \$1,950,000
Council Rates: \$382.00 p/q
Water Rates: \$146.00 p/q



Chris Elliott
 0410 416 066



Chris Lewis
 0431 179 861



Basement



1st Level



Ground Level



6/190 Sydney Road
Fairlight

STONE

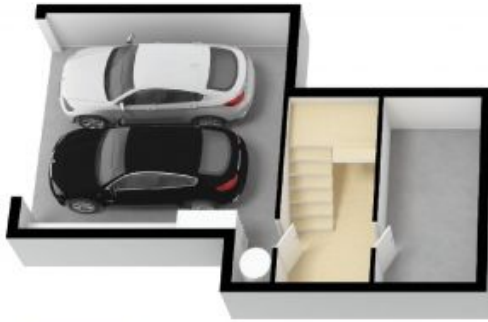

Basement



1st Level



Ground Level

The floor plan is not to scale; measurements are indicative and in metres. All features included in this 3D plan are for inspiration purposes only. This is not an exact replica of the property or the position of exterior elements. Plans should not be relied on. Interested parties should make and rely on their own enquiries.

