



7 Widewood Court Heritage Park, QLD



ONE LOOK IS ALL YOU NEED

Set in a quiet court location in the sought-after suburb of Heritage Park is this lovely 4-bedroom family home, within walking distance to local schools, shops, parks and local transport.

Offering a large light filled lounge and dining area, functional kitchen, tiled family room with door access to the covered entertaining area, 4 carpeted bedrooms, the master with ensuite and walk-in robe, plus a double lock up garage with drive through and internal entry.

This home has been very loved and has had a freshen up ready for your enjoyment, plenty of room for the growing family and a spacious private rear yard perfect for children and pets to run around safely.

With local amenities within walking distance and access to the major motorways to Brisbane CBD, Brisbane Airport and the Gold Coast a short drive away, this home is sure to be very popular.

Price: \$655,000



Claire Franklin

0430 438 889



Approx. Floor Area | Internal 172 m² | External 35 m² | Total 207 m²

Unless otherwise stated, all dimensions are in metres. Star arrows indicate the upward direction. This plan and information contained within is for illustrative purposes only and not guaranteed to be exact. Interested parties should make their own enquiries.



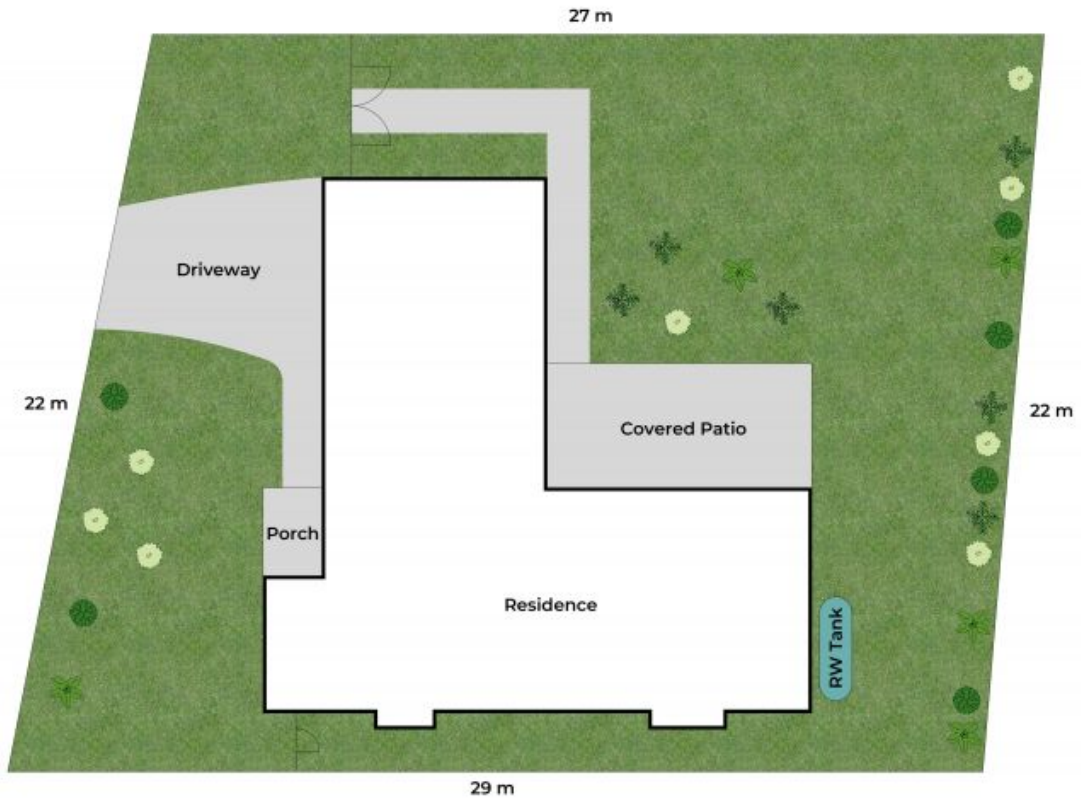

Lot Area | 617 m²

Unless otherwise stated, all dimensions are in metres. Star arrows indicate the upward direction. This plan and information contained within is for illustrative purposes only and not guaranteed to be exact. Interested parties should make their own enquiries.