



22 Mount Roberts Street PARK RIDGE, QLD

3 

2 

2 

Another Successful Result by the Team at Your Address

This wonderful contemporary low maintenance 3 bed plus study home is only 4 years old and has been designed and built by Metricon homes. It is situated on a private battle-axe block complete with its own driveway offering both security and privacy. The attention to detail is immeasurable and there is really nothing left to do but move in and enjoy, the homeowners standard of presentation and cleanliness is of such a high standard, even down to the Kashmiri jade pebbles used along the side yard to add a green sheen when wet!

Price:

SOLD by the Team at Your Address



Claire Franklin

0430 438 889



Approx. Floor Area | Internal 182 m² | External 24 m² | Total 206 m²



UNLESS OTHERWISE STATED, ALL DIMENSIONS ARE IN METRES. THIS PLAN AND INFORMATION CONTAINED WITHIN IS FOR ILLUSTRATIVE PURPOSES ONLY AND NOT GUARANTEED TO BE EXACT. INTERESTED PARTIES SHOULD MAKE THEIR OWN ENQUIRIES.

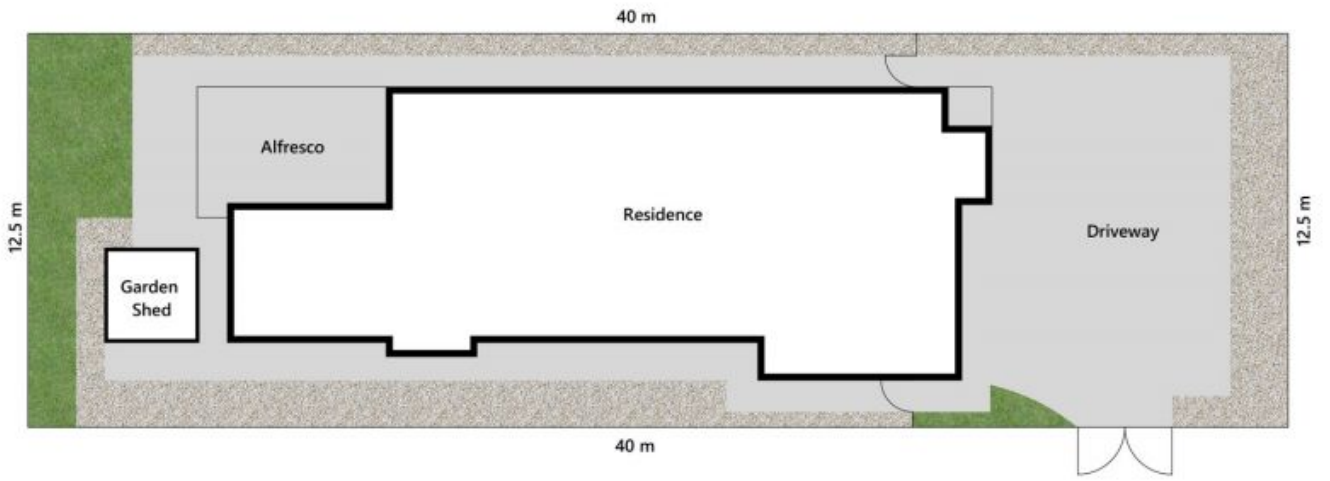

Lot Area | 500 m²



UNLESS OTHERWISE STATED, ALL DIMENSIONS ARE IN METRES. THIS PLAN AND INFORMATION CONTAINED WITHIN IS FOR ILLUSTRATIVE PURPOSES ONLY AND NOT GUARANTEED TO BE EXACT. INTERESTED PARTIES SHOULD MAKE THEIR OWN ENQUIRIES.