



YOURaddress®



13 Taronga Court HERITAGE PARK, QLD

3

2

1

Another Successful Result by the Team at Your Address

This wonderful home set in a court location in Heritage Park with gorgeous landscaped gardens is sure to delight the most avid buyer, offering 3 generous sized bedrooms, master with ensuite, spacious open plan light filled lounge and dining area with reverse cycle air-conditioning, bay window and glass sliding doors leading out to the covered entertaining area, tiled dining/family area with reverse cycle air-conditioning and glass sliding doors opening onto the covered entertaining area plus a well-appointed kitchen.

Set in a perfect location with local schools, shops, bus stops and amenities within walking distance and access to the major motorway links to Brisbane CBD and the Gold Coast only a short drive.

Price:

SOLD by the Team at Your Address



Claire Franklin

0430 438 889



Approx. Floor Area | Internal 135 m² | External 19 m² | Total 154 m²

UNLESS OTHERWISE STATED, ALL DIMENSIONS ARE IN METRES. THIS PLAN AND INFORMATION CONTAINED WITHIN IS FOR ILLUSTRATIVE PURPOSES ONLY AND NOT GUARANTEED TO BE EXACT. INTERESTED PARTIES SHOULD MAKE THEIR OWN ENQUIRIES.



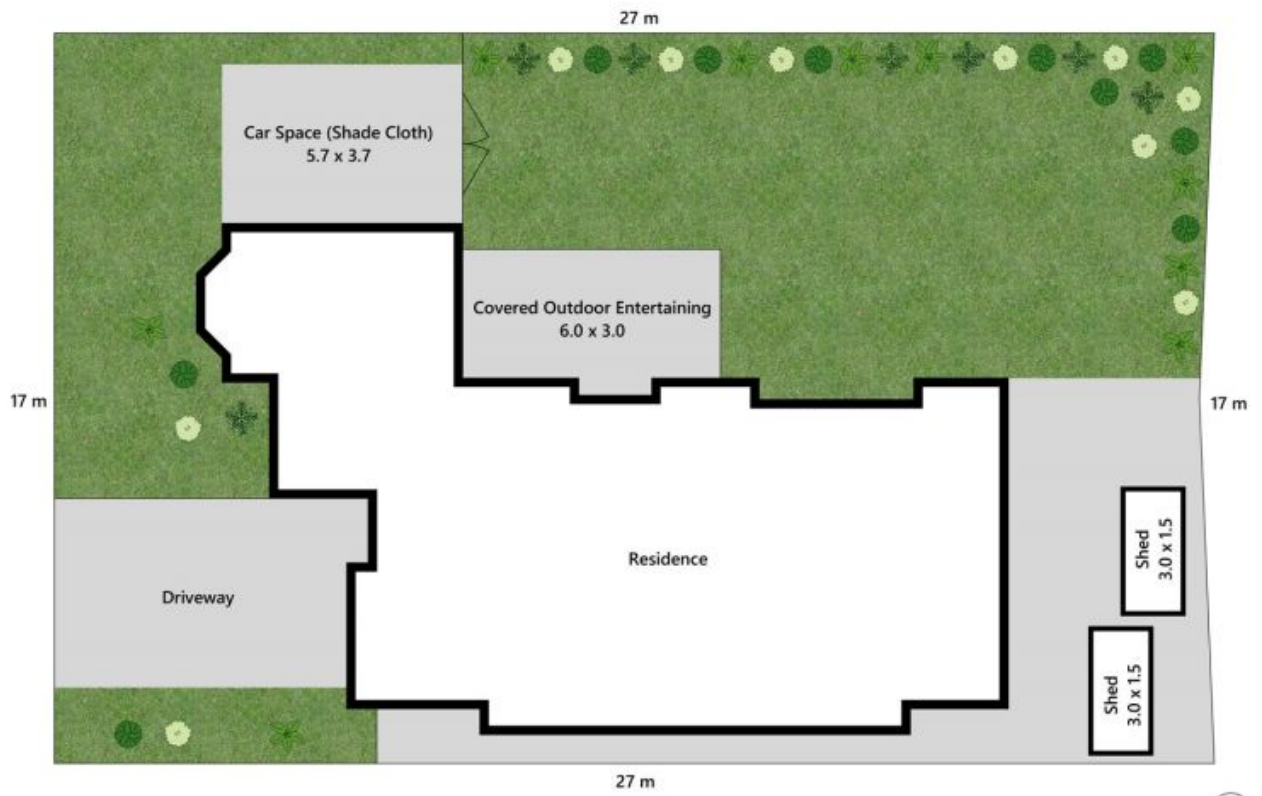

Lot Area | 461 m²

UNLESS OTHERWISE STATED, ALL DIMENSIONS ARE IN METRES. THIS PLAN AND INFORMATION CONTAINED WITHIN IS FOR ILLUSTRATIVE PURPOSES ONLY AND NOT GUARANTEED TO BE EXACT. INTERESTED PARTIES SHOULD MAKE THEIR OWN ENQUIRIES.

