



YOUR address®



your address®
REAL ESTATE



your address®
REAL ESTATE



your address®
REAL ESTATE

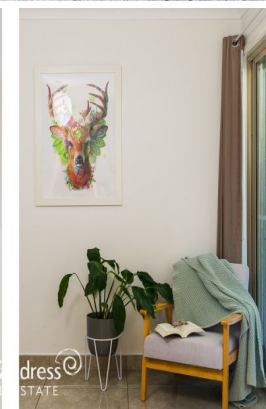

25 Glenlyon Street MARSDEN, QLD

3 

2 

2 

Another Successful result by the Team at Your Address

Price:

SOLD by the Team at Your Address

No expensive renovation required here! Just move in and sit back and enjoy this wonderful home with fantastic presentation throughout.



Griffiths & Gunn

0430445750



Approx. Floor Area | Internal 128 m² | External 61 m² | Total 189 m²



UNLESS OTHERWISE STATED, ALL DIMENSIONS ARE IN METRES. THIS PLAN AND INFORMATION CONTAINED WITHIN IS FOR ILLUSTRATIVE PURPOSES ONLY AND NOT GUARANTEED TO BE EXACT. INTERESTED PARTIES SHOULD MAKE THEIR OWN ENQUIRIES.

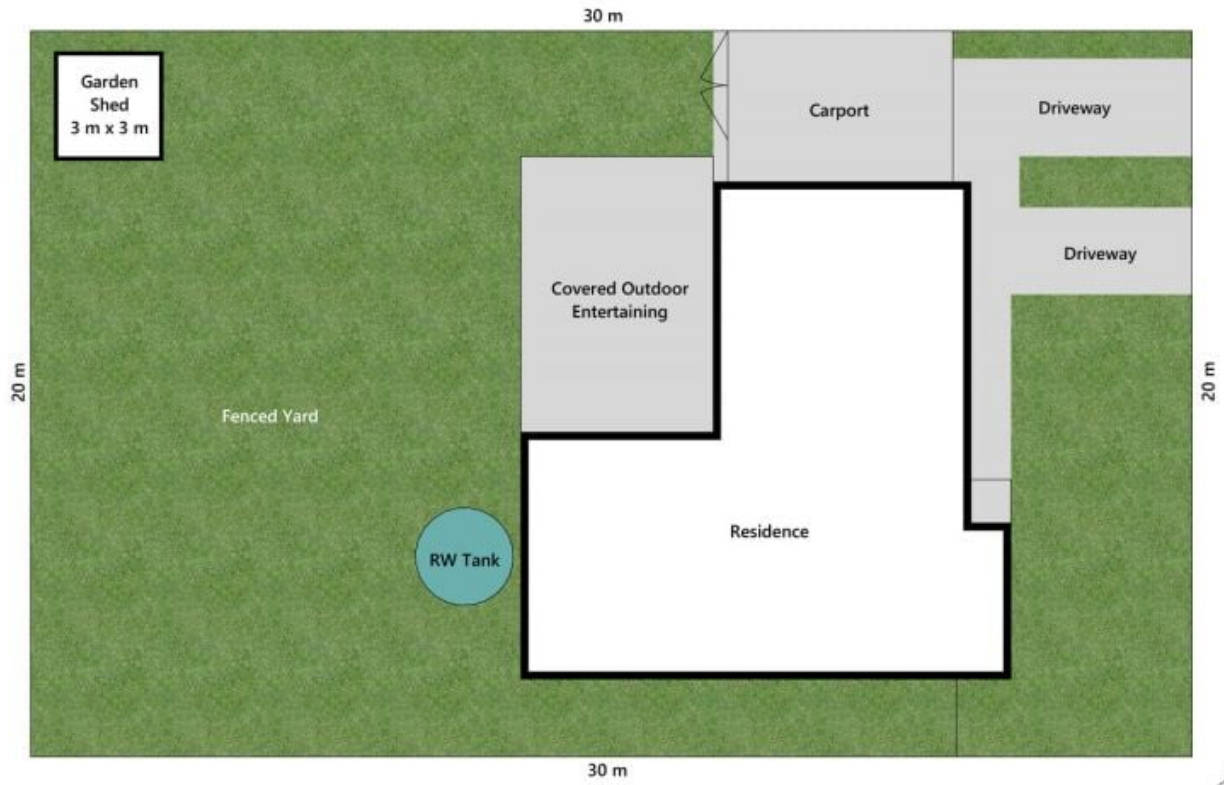

Lot Area | 640 m²

UNLESS OTHERWISE STATED, ALL DIMENSIONS ARE IN METRES. THIS PLAN AND INFORMATION CONTAINED WITHIN IS FOR ILLUSTRATIVE PURPOSES ONLY AND NOT GUARANTEED TO BE EXACT. INTERESTED PARTIES SHOULD MAKE THEIR OWN ENQUIRIES.

