



YOUR address



your address REAL ESTATE



your address REAL ESTATE



your address REAL ESTATE

1-3 Sherbrooke Court MUNRUBEN, QLD

3

2

4

Another Successful Result by the Team at Your Address

Price:

CONTACT AGENT

Filled with creative energy, this architecturally designed pole home boasts a flowing open plan design that offers light-filled living spaces that are perfectly positioned to capture the outdoor views with the expansive windows and glass doors.



Griffiths & Gunn

0430445750

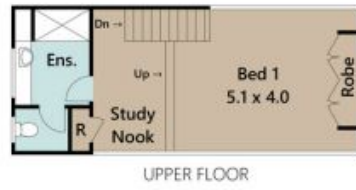
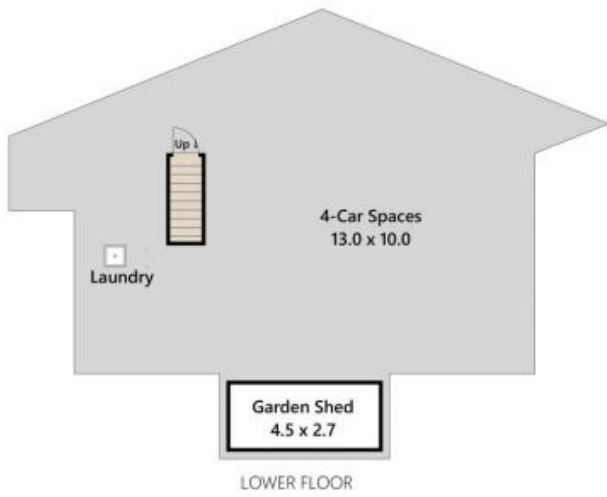

Approx. Floor Area | Internal 158 m² | External 182 m² | Total 340 m²

UNLESS OTHERWISE STATED, ALL DIMENSIONS ARE IN METRES. THIS PLAN AND INFORMATION CONTAINED WITHIN IS FOR ILLUSTRATIVE PURPOSES ONLY AND NOT GUARANTEED TO BE EXACT. INTERESTED PARTIES SHOULD MAKE THEIR OWN ENQUIRIES.



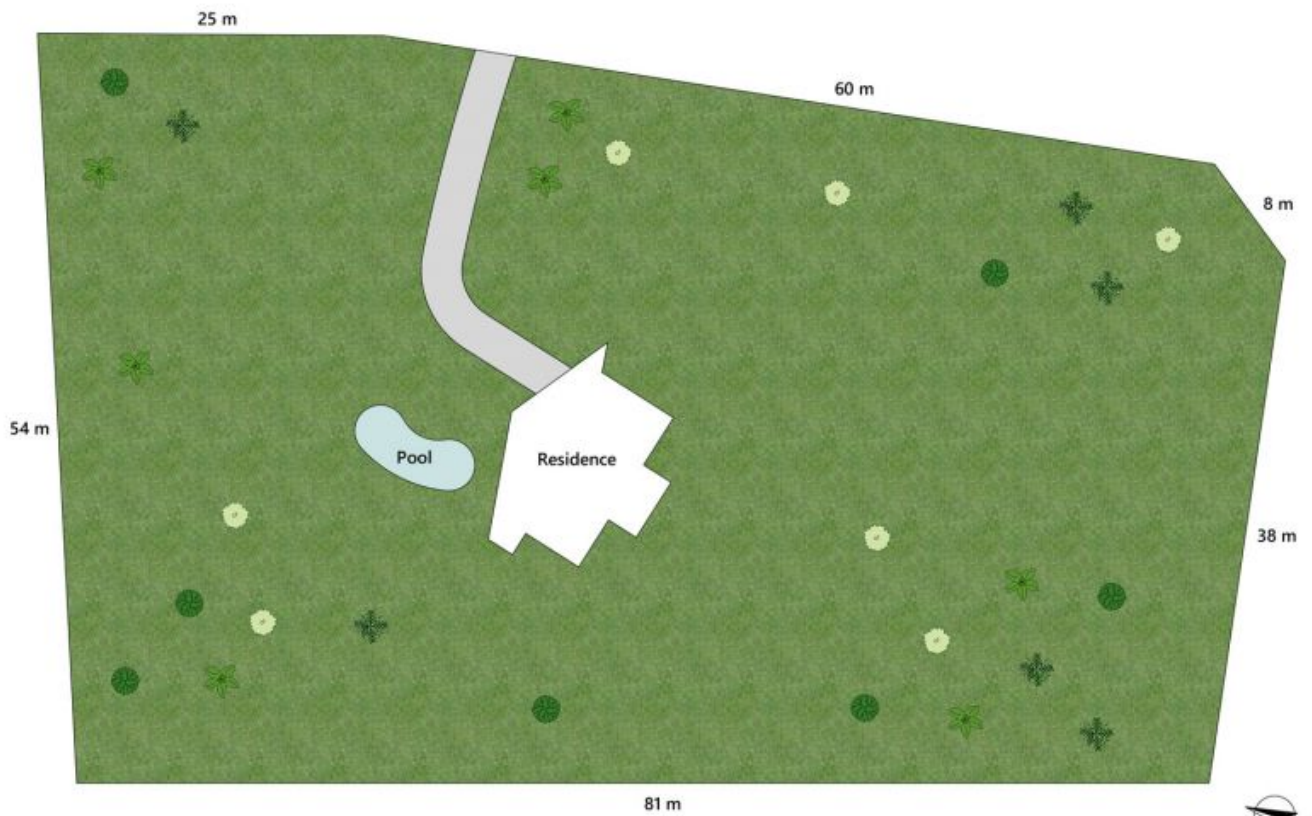

Lot Area | 4,280 m²

UNLESS OTHERWISE STATED, ALL DIMENSIONS ARE IN METRES. THIS PLAN AND INFORMATION CONTAINED WITHIN IS FOR ILLUSTRATIVE PURPOSES ONLY AND NOT GUARANTEED TO BE EXACT. INTERESTED PARTIES SHOULD MAKE THEIR OWN ENQUIRIES.