



26 Lansdown Road WATERFORD WEST, QLD 3 1 1

FULLY FENCED! OFF STREET PARKING! GARAGE BUILT-IN!

Price: \$309,000

Lansdown Green Estate is the perfect location, right in the middle of everything that you need Shopping Centres, Fast food outlets, Fruit shops, Train Station, Bus stops and Marsden High School Catchment, plus the Motorway is 5 minutes away. The property itself offers so much with secure off street parking, a rumpus room / 3rd bedroom, large lounge room plus a separate dining area, all situated on a low maintenance 434m2 block.

**Stone Real Estate -
Head Office**



Internal Area 90 m² | External Area 68 m² | Total Area 158 m²

WHILE EVERY EFFORT IS MADE TO ENSURE THAT THIS PLAN AND INFORMATION CONTAINED WITHIN IS AS ACCURATE AS POSSIBLE, IT IS FOR ILLUSTRATIVE PURPOSES ONLY AND NOT GUARANTEED TO BE EXACT. INTERESTED PARTIES SHOULD MAKE THEIR OWN ENQUIRIES.



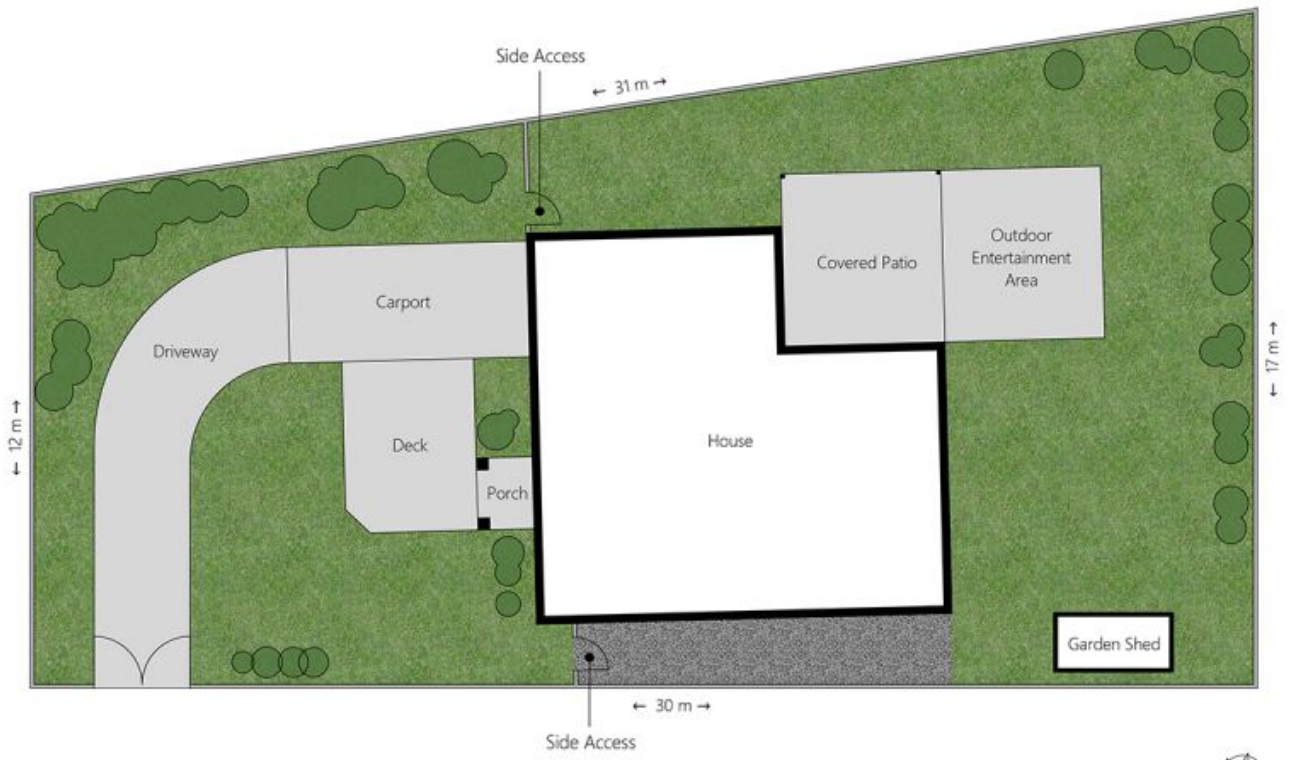

WHILE EVERY EFFORT IS MADE TO ENSURE THAT THIS PLAN AND INFORMATION CONTAINED WITHIN IS AS ACCURATE AS POSSIBLE, IT IS FOR ILLUSTRATIVE PURPOSES ONLY AND NOT GUARANTEED TO BE EXACT. INTERESTED PARTIES SHOULD MAKE THEIR OWN ENQUIRIES.

